

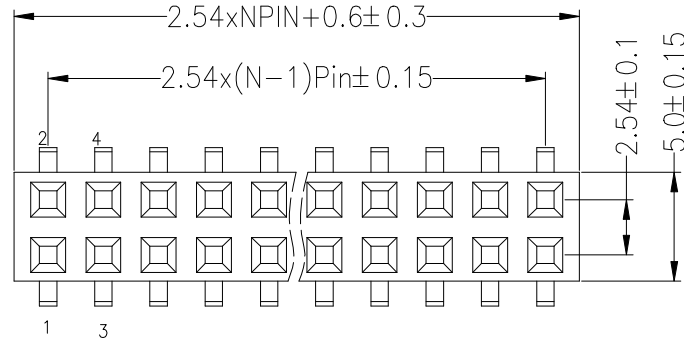

**SPECIFICATIONS**

Rated Current:3.0AMP  
 Contact Resistance:20mΩ Max  
 Withstand Voltage:1000V AC/DC  
 Insulation Resistance:1000MΩ Min  
 Operation Temperature:-40°C to +105°C

Contact Material:Phosphor Bronze  
 Contact Plating:Au or Sn Over Ni  
 Insulator Material:Polyester(UL94V-0)  
 Standard: PA6T  
 Max.Processing Temp: 230°C for 30-60 seconds  
 (260°C for 10 seconds)



Recommended P.C.B Layout(Top Side)  
 (PCB BOARD TOLERANCE±0.05)

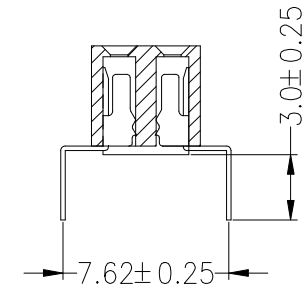
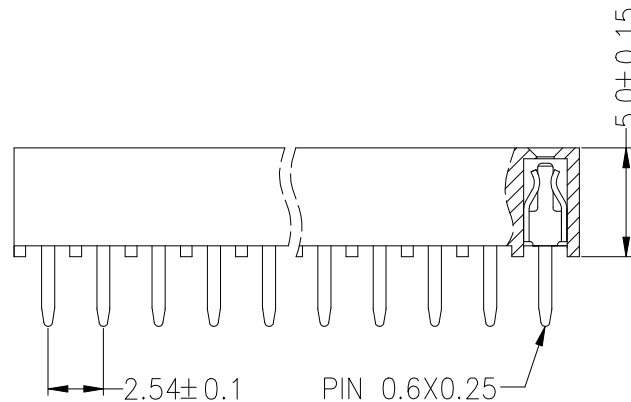
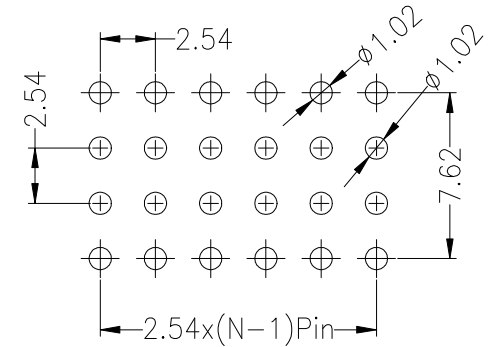

**Ordering Information**

2250 02 XX X N XX W U X 0X

No.of Pins Per Row 2-40	Insulator Material Option A=BK-PBT C=BK-PA6T D=BK-PA46 E=BK-PA9T F=BK-LCP	Contact Plating G1:Gold Flash G2:1.5U" Gold G3:2U" Gold G4:3U" Gold G5:5U" Gold S0:Gold Flash/Tin SN:Tin	Packing 0=PE Bag A=Tray T=Tube P=Tube+Cap R=Reel+Cap M=Reel+Mylar
----------------------------	--	---	---

				OPERATION		DRAW	YiYuSheng	20.08.06	SCALE	FIT	<b>JILN® 深圳市锦凌电子有限公司</b> <b>SHENZHEN JINLING ELECTRONIC CO.,LTD</b> Tel: 86-755-2997-5806/5802 Fax: 86-755-2997-5992	
				X.X	±0.30				UNIT	mm		
				X.XX	±0.20	CHECK		SIZE	A4	PART NO.		225002XXXXXWUX0X
				X.XXX	±0.10		APPROVE		SHEET	1/1	TITLE:	
A0	2020.08.06	NEW DRAWING		Angle	±3°				PROJ.	◆		
REV	DATE	MODIFICATION DESCRIPTION	CHANGE	DIM	TOL							
1	2	3	4	5	6	7	8	9				