

RoHS

* 针头歪斜度3°

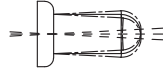

Notes:

1. Materials:
 - 1.1 Plunger: Brass C3604
 - 1.2 Barrel: Brass C3604
 - 1.3 Spring: SUS304
2. Plating:
 - 2.1 Plunger: 3u" Au over 50-120u" Ni
 - 2.2 Barrel: 3u" Au over 50-120u" Ni
3. Electrical
 - 3.1 Rated Current & Voltage: DC12V, 1.0A
 - 3.2 Contact Resistance: 100mΩ Max. at working height
4. Operational Temperature: -40°C ~ +85°C
5. Mechanical
 - Force: 100±20g, at working height
 - Durability: 10000 cycles
6. 12H delay test

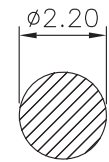
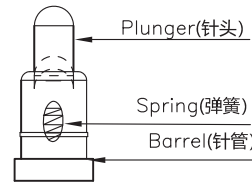
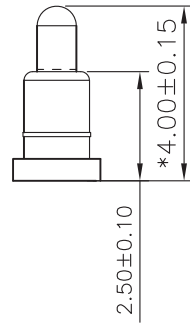
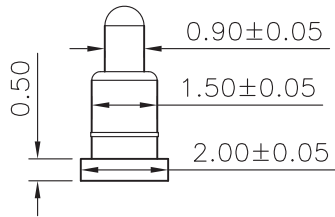

PCB LAYOUT

5.0				DRAWING:	GENERAL TOLERANCE .X: = ±0.30 .X°: = ±2° .XX: = ±0.20 .XX°: = ±1° .XXX: = ±0.10 .XXX°: = ±0.5°	CHIN-BAN Electroic Technology
4.0				Frank		
3.0				CHECKED:	UNIT: MM PROJECTION:	DESCRIPTION: POGO pin Connector
2.0				yang jie		
1.0				APPROVAL:	SCALE: 1/1	SERIES: PG1000 SERIES
REV.	DATE	DESCRIPTION	DRAWING		SHEET: 1/1	PART NO: PG1000-01-013P
						CUSTOMER P/N:
						REV: 1.0
						SIZE: A4