

CIRCUIT DIAGRAM

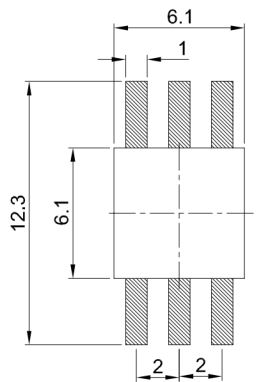

RECOMMENDED PCB LAYOUT
TOLERANCE:±0.05



PS-58 50 S V X-6P N W

Push Switch

Switch Type
58=5.8×5.8mm

Switch Height(mm)
50=5.0mm

Foot Type
S=SMT

LINE
W=No direction

Switch Function
N=No Lock
L=Lock

Foot Position
6P=6pin

Operating Force
A=180gf
B=250gf

Type
V=Vertical

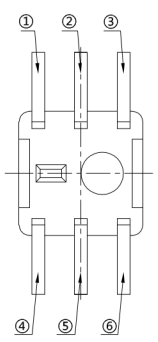
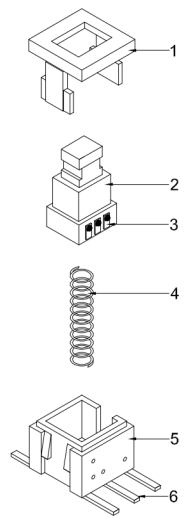
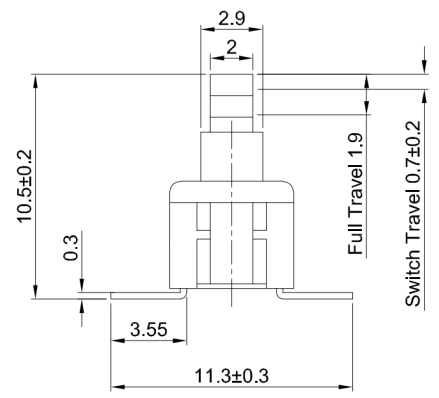
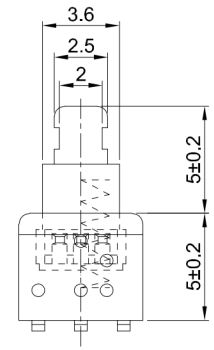

G-Switch Specification:

- Operating temperature range: -40°C ~ +85°C
- Rating: 0.5A,24V DC
- Insulation resistance: 100MΩ min,100V DC
- Dielectric strength: 250V AC for 1 min
- Contact resistance: 100mΩ max.
- Switch lifetime: 30,000Cycles

6	TERMINAL	BRASS	Ag PLATED
5	CASE	PPA	BLACK
4	SPRING	SUS WIRE	NATURAL
3	CONTACT	BRONZE	Ag PLATED
2	KNOB	PPA	WHITE
1	COVER	PPA	BLACK
NO.	PART NAME	MATERIAL	REMARK



SCALE: 1:1	UNIT: mm	Title: Vertical Tact Switch SMT 5.8×5.8×H10.5mm			
SIZE: A4		Molde Code: PS-5850SVX-6PNW			
Unless otherwise General Tolerance:		DRAWN	CHECKED	APPROVED	DATE
X	±0.40	Xia	Chen	Chen	2024.03.10
X.x	±0.30	REV: A0 SHEET: 1/1			
X.xx	±0.20	www.dg-switch.com			
X°	±5°				
X.x°	±3°				

