

- G-Switch USB-C Specification:**
- 1.Current rated: 5A on vbus/1.25A on vconn/0.25A on other
Voltage rating: 24V AC
 - 2.Withstanding voltage: 100V AC/minute
 - 3.Contact resistance: 40mΩ Max
 - 4.Insulation resistance: 100MΩ Min
 - 5.Operating temperature: -40°C ~ +85°C
 - 6.Mating force: 5N~20N
 - 7.Unmating force: 8N~20N
 - 8.Durability cycle:10,000 cycles

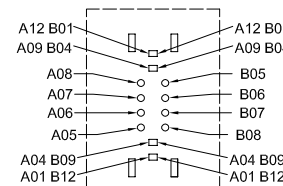
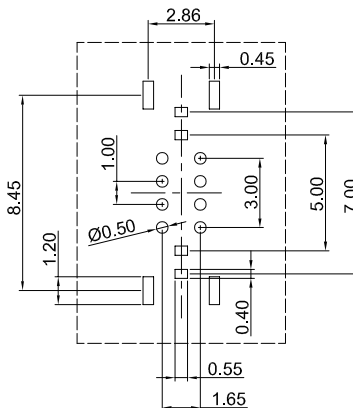
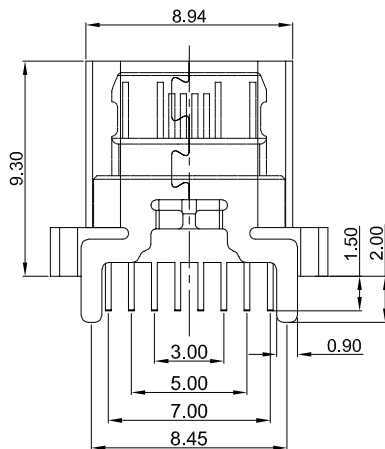

| | | | | | | | | | | | |
|-------|-----|-----|-------|--------|--------|--------|--------|-------|-----|-----|-------|
| A1 | A2 | A3 | A4 | A5 | A6 | A7 | A8 | A9 | A10 | A11 | A12 |
| GND | | | VBUS | CC1 | D+ | D- | SBU1 | VBUS | | | GND |
| First | | | First | Second | Second | Second | Second | First | | | First |
| B12 | B11 | B10 | B9 | B8 | B7 | B6 | B5 | B4 | B3 | B2 | B1 |
| GND | | | VBUS | SBU2 | D- | D+ | CC2 | VBUS | | | GND |
| First | | | First | Second | Second | Second | Second | First | | | First |

PCB REFERENCE DIAGRAM
TOLERANCE:±0.05

| | | | |
|-----|-----------|---------------------|---|
| 1 | SHELL | STAINLESS STEEL 201 | Ni PLATED |
| 2 | MID PLATE | STAINLESS STEEL 201 | Ni PLATED |
| 3 | HOUSING | LCP | BLACK UL 94 V-0 |
| 4 | TERMINALS | COPPER ALLOY C2680 | Au PLATING ON CONTACT AREA Tin PLATED ON SOLDER AREA |
| NO. | PARTS | MATERIAL | REMARKS |

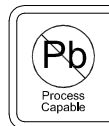

SCALE: 1:1 UNIT: mm
SIZE: A4

Unless otherwise
General Tolerance:
X. ±0.40
X.x ±0.30
X.xx ±0.20
X.xxx ±0.10
X* ±5°

| | | | |
|--|---------|----------|------------|
| Title: Vertical Type-C 16P Female DIP H=9.3mm | | | |
| Molde Code: GT-USB-7038A | | | |
| DRAWN | CHECKED | APPROVED | DATE |
| Xia | Chen | Chen | 2024.11.19 |



REV: A1 SHEET: 1/1