

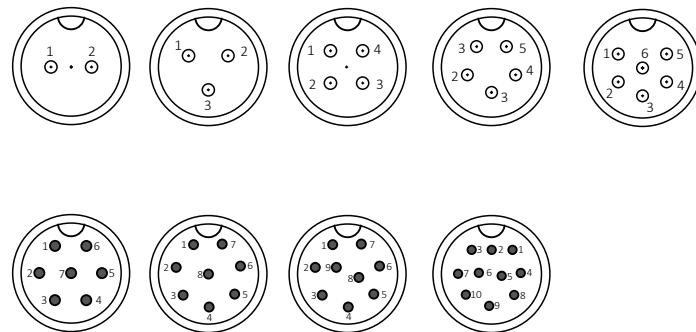

版本	描述	变更编号	日期
A	首次发行	---	2024/09/21

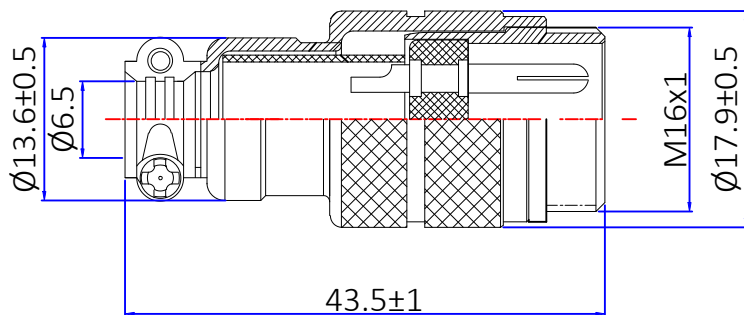

Material and specifications
 Coupling Threaded coupling
 Shell material Zinc alloy with nikelplate
 Insert material bakelite
 Contact material copper(silverplated/gold)
 Termination Solder
 Mating cycle 500
 Temperature range -20° C +85° C
 Protection Level: IP55

Technology parameter									
NO.of contacts	2	3	4	5	6	7	8	9	10
Rated current (A)	7	7	7	7	5	5	5	5	5
Operation limit voltage(AC.V.rms)	220	220	125	125	125	125	125	125	125
Withstanding voltage(AC.V.rms) 1 minute	1500	1500	1500	1500	1500	1500	1500	1500	1500
Insulation resistance (mΩ)	2000	2000	2000	2000	2000	2000	2000	2000	2000
Contact resistance (mΩ)	3	3	3	4	5	5	4	5	5
Solder cup mouth aperture	Ø1.4	Ø1.4	Ø1.4	Ø1.2	Ø0.8	Ø0.8	Ø0.8	Ø0.8	Ø0.8
Solder inter diameter	Ø2.5	Ø2.5	Ø2.5	Ø2.0	Ø1.2	Ø1.2	Ø1.2	Ø1.2	Ø1.2

The View		dosinconn DOSIN INDUSTRIAL(HK)CO.,LTD Web: https://www.dosinconn.cn/	
单位 unit	mm	页码 page	1/1
图号 Drawing NO		料号 Part Number	产品名称 Product name
文件保密 File security This drawing shall not be copied, circulated or used for other purposes without permission. 本图纸未经允许，不可复制、外传或它用		未注公差 Unmarked tolerance	绘图 Draw drawing
		零部件 Parts X. ±0.30 X.X ±0.20 X.XX ±0.10	线性 Line ≤10 ±1 10~50 ±1.5 >50 ±4%
		角度 angle ±3°	审核 Check
			客户确认 Customer confirmation

江门市德索连接器有限公司
 Jiangmen Dosin Connector Co., LTD

Mailbox: sale@dosin.cn
 Tel: (0086)769-81153906

料号 DS869FCS0656
 Part Number

产品名称 GX16 直母头
 Product name

绘图 邓高
 Draw drawing

审核
 Check

客户确认
 Customer confirmation