

RECOMMEND P.C.B LAYOUT
PCB TOLERANCE:±0.05 (TOP VIEW)

SPECIFICATIONS
 Current Rating:0.75 Amps
 Withstanding Voltage:AC 500V
 Insulation Resistance:1000MΩ Min
 Contact Resistance:20mΩ Max
 Operation Temperature:-40°to+105°
 Insulator Material:Polyester(UL94V-0)
 Contact Material:Phosphor bronze
 Standard:PA6T
 Contact Plating:Gold Flash
 Max.Processing Temp:240°C for30-60seconds
 (260°C for5seconds)

P/N	PIN	DIM.A	DIM.B
BX-PZ1.0-1-1PWZ	1	0.00	1.0000
BX-PZ1.0-1-2PWZ	2	1.0000	2.00
BX-PZ1.0-1-3PWZ	3	2.00	3.00
BX-PZ1.0-1-4PWZ	4	3.00	4.00
BX-PZ1.0-1-5PWZ	5	4.00	5.00
BX-PZ1.0-1-6PWZ	6	5.00	6.00
BX-PZ1.0-1-7PWZ	7	6.00	7.00
BX-PZ1.0-1-8PWZ	8	7.00	8.00
BX-PZ1.0-1-9PWZ	9	8.00	9.00
.....
BX-PZ1.0-1-40PWZ	40	(PIN-1)	(PIN)

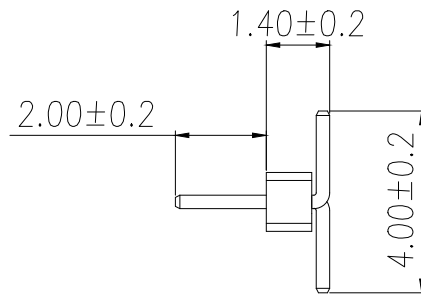
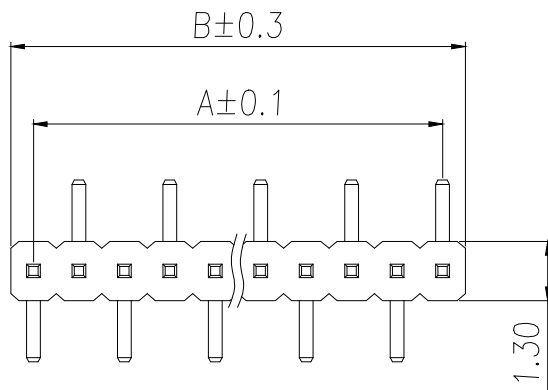

制图 DRAWN	变更内容 DESCRIPTION	日期 DATE	GENERAL TOLERANCE	
			X.±0.30	X.*±5°
			.X±0.20	.X*±1°
			.XX±0.10	.XX*±0.5°

制图 DRAWING	EMMA
审核 CHECK	EVA
核准 APPROVAL	JADE
单位 UNITS	MM 比例 SCALE 1:1

料号 PART NO.	BX-PZ1.0-1-NPWZ	版本 REV.	A
品名 TITLE	1.0PH H1.0 2xPin SMT W2.3 PCS.0 PA2.0 PB1.4 LS.0 6T	页次 SHEET	1/1
客户料号 CUTM.NO.			

Bossie (博锡)