

⊠ = ASO ONLY (APPLICATION SPECIFIC ORDER)

* = NOT RELEASED FOR PRODUCTION

DO NOT SCALE FROM THIS PRINT

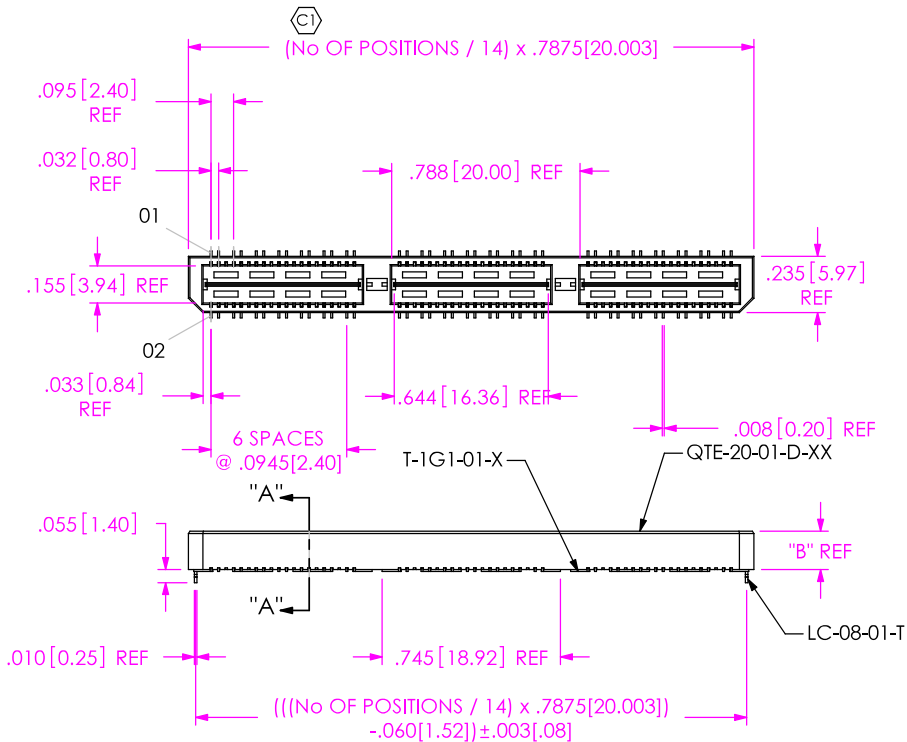

-LC: LOCKING CLIP OPTION SHOWN

FIG. 1

QTE-042-01-X-D-DP-LC SHOWN

QTE-XXX-XX-X-D-DP-XX

- No OF POSITIONS**
 - 014, -028, -042, -056, -070 (PER ROW)
- LEAD STYLE**
 - 01: .1680 [4.267] (SEE FIG.1)
 - 02: .2861 [7.264] (SEE FIG.1)
 - 03: .4042 [10.267] (SEE FIG.1)
 - 04: .600 [15.24] (SEE FIG. 4, SHT. 3)
 - 05: .718 [18.237] (SEE FIG. 4, SHT. 3)
 - 06: .835 [21.209] (SEE FIG. 4, SHT. 3)
 - 07: .954 [24.232] (SEE FIG. 4, SHT. 3)
 - 08: 1.151 [29.24] (SEE FIG. 4, SHT. 3)
 - 09: .522 [13.258] (SEE FIG. 4, SHT. 3)
 - 10: .5606 [14.239] (SEE FIG. 4, SHT. 3)
- OPTION**
 - A: ALIGNMENT PINS
 - LC: LOCKING CLIPS (USE LC-08-TM-01)
 - K: POLYAMIDE FILM (USE K-500-300) (SEE FIG. 2, SHT. 2) (N/A ON STYLES -07 & -08)
 - GP: GUIDE POSTS (AVAILABLE ON -01 ONLY) (USE QTE-20-01-D-XX-X-GP) (SEE FIG. 3, SHT. 2)
 - TR: TAPE & REEL (42 POS. MAX) (NOT AVAILABLE ON -05, -06, -07, -08 LEAD STYLES) (028 POS MAX FOR -GP OPTION)
 - TY: TRAY PACKAGING (NOT AVAILABLE FOR -TR)
 - RT1: RETENTION OPTION (SEE FIG. 7, SHEET 4) (ONLY AVAILABLE ON -01 LEAD STYLE) (MUST USE -A OPTION) (USE QTE-20-01-D-XX-A-RT1 & T-1R36-01-F) (NOT AVAILABLE WITH -LC, -GP, -SD, OR -FL) (NOT AVAILABLE ON -056 & -070 POS)
- PLATING SPECIFICATION**
 - F: FLASH SELECTIVE GOLD (USE T-1SXX-XX-F, T-1G1-XX-F)
 - L: LIGHT SELECTIVE GOLD (USE T-1SXX-XX-L, T-1G1-XX-G)
 - H: HEAVY GOLD (USE T-1SXX-XX-H, T-1G1-XX-G)
- BODY STYLE**
 - DP: DIFFERENTIAL PAIRS
- ROW SPECIFICATION**
 - D: DOUBLE (USE QTE-20-XX-D-XX & QTEH-20-XX-D-XX)

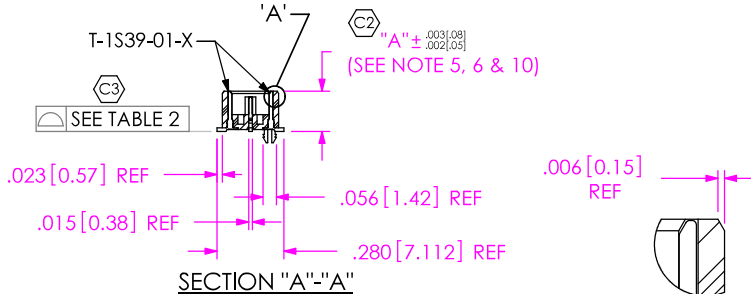

- NOTES:
1. ⊕ REPRESENTS A CRITICAL DIMENSION.
 2. MINIMUM TERMINAL RETENTION: 5 OZ.
 3. MINIMUM GROUND PLANE RETENTION: 1 LB.
 4. PARTS TO BE MOLDED TO POSITION.
 5. MAXIMUM VARIANCE OF .002 [0.05].
 6. DIMENSION APPLIES TO TERMINALS AND GROUND PLANE.
 7. DELETED.
 8. DELETED.
 9. -L PLATING CAN BE SUBSTITUTED FOR -F PLATING.
 10. GROUND PLANE PRESS HEIGHT MUST BE .003[0.08] LESS THAN THE MAX HEIGHT OR .001[0.03] GREATER THAN THE MINIMUM HEIGHT OF THE TERMINALS.
 11. T-1R36 RETENTION TO BODY TO BE 1.0 LBF.

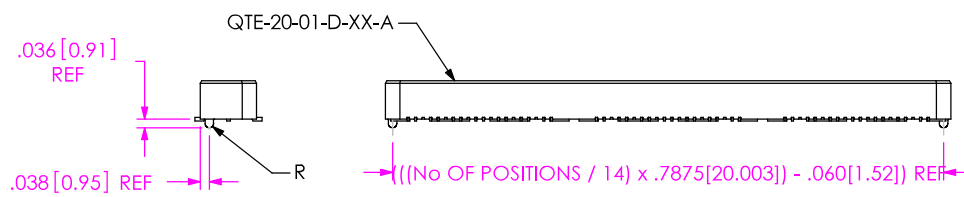

-A: ALIGNMENT PIN OPTION SHOWN (STYLES -01, -02 & -03)

TABLE 2	
COPLANARITY (INCLUDES GROUND PLANE)	
No OF POSITIONS	
-014 THRU -042	.0040 [.10]
-056 THRU -070	.0060 [.15]

TABLE 1						MATED HEIGHT WITH QSE-DP-01
STYLE	"A"	"B"	BODY	GROUND PLANE	TERMINAL	
-01	.1680 [4.267]	.1600 [4.064]	QTE-20-01-D-XX	T-1G1-01-X	T-1S39-01-X	.197 [5.00] REF
-02	.2861 [7.267]	.2781 [7.064]	QTE-20-02-D-XX	T-1G1-02-X	T-1S59-02-X	.315 [8.00] REF
-03	.4042 [10.267]	.3962 [10.063]	QTE-20-03-D-XX	T-1G1-03-X	T-1S39-03-X	.433 [11.00] REF

UNLESS OTHERWISE SPECIFIED, DIMENSIONS ARE IN INCHES. TOLERANCES ARE:

DECIMALS	ANGLES
.XX: ±.01 [.3]	2°
.XXX: ±.005 [.13]	
.XXXX: ±.0020 [.051]	

PROPRIETARY NOTE
THIS DOCUMENT CONTAINS INFORMATION CONFIDENTIAL AND PROPRIETARY TO SAMTEC, INC. AND SHALL NOT BE REPRODUCED OR TRANSMITTED TO OTHER DOCUMENTS OR DISCLOSED TO OTHERS OR USED FOR ANY PURPOSE OTHER THAN THAT WHICH IT WAS OBTAINED WITHOUT THE EXPRESSED WRITTEN CONSENT OF SAMTEC, INC.

SAMTEC
520 PARK EAST BLVD. NEW ALBANY, IN 47150
* PHONE: 812.944.6733 FAX: 812.948.5047
E-Mail: INFO@SAMTEC.COM CODE: 55322

MATERIAL: DO NOT SCALE DRAWING SHEET SCALE: 1.25:1

INSULATOR: LCP, BLACK
TERMINAL: PHOS BRONZE
GROUND PLANE: PHOS BRONZE

DESCRIPTION:
.8mm DIFFERENTIAL PAIRS HS TERMINAL ASSEMBLY

DWG. NO.
QTE-XXX-XX-X-D-DP-XX

BY: DEAN P 4/28/2000 SHEET 1 OF 4

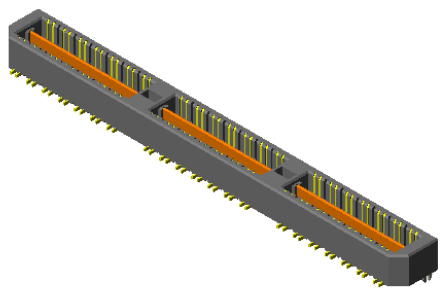

FIG. 2

-K: POLYAMIDE FILM PAD
[USE K-500-300]

NOTE: "R" = (No OF POSITIONS / 14) x .7875[20.003]
"S" = (("R" - .275[6.99]) / 2) ±.020[.51]

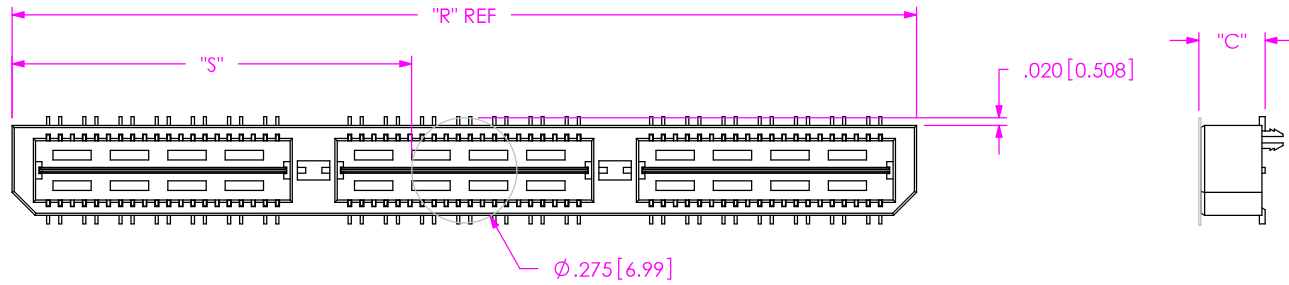
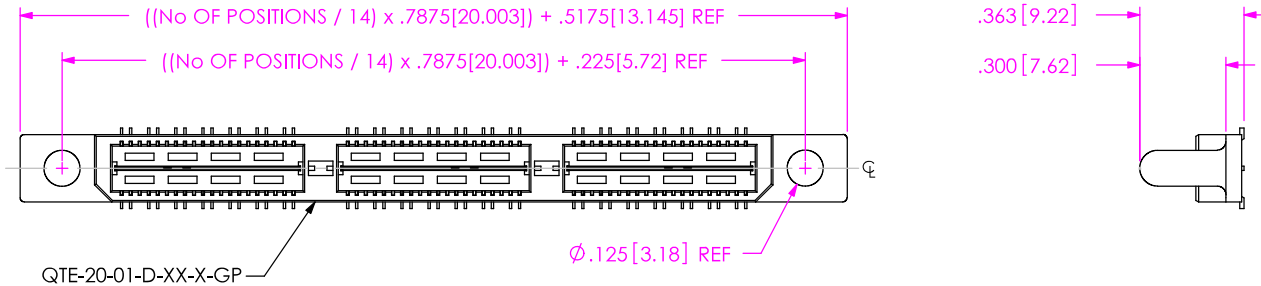

TABLE 3

STYLE	"C"
-01	.173[4.39]
-02	.291[7.39]
-03	.409[10.39]
-04	.605[15.37]
-05	.723[18.36]
-06	.841[21.36]
-09	.527[13.39]
-10	.567[14.37]

FIG. 3

-GP: GUIDE POST OPTION
(-01 LEAD STYLE ONLY)
(SAME AS FIG. 1, UNLESS OTHERWISE STATED)



QTE-20-01-D-XX-X-GP

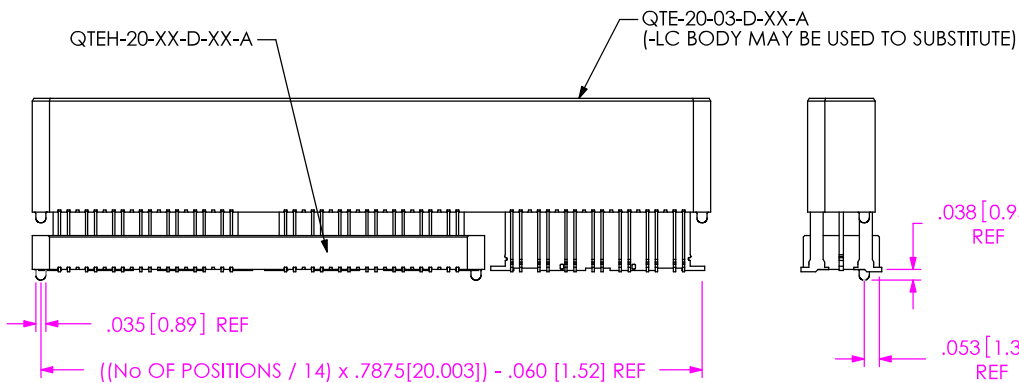

-A: ALIGNMENT PIN OPTION
(STYLES -04, -05, -06, -07, -08, -09, -10)

PROPRIETARY NOTE

THIS DOCUMENT CONTAINS INFORMATION CONFIDENTIAL AND PROPRIETARY TO SAMTEC, INC. AND SHALL NOT BE REPRODUCED OR TRANSFERRED TO OTHER DOCUMENTS OR DISCLOSED TO OTHERS OR USED FOR ANY PURPOSE OTHER THAN THAT WHICH IT WAS OBTAINED WITHOUT THE EXPRESSED WRITTEN CONSENT OF SAMTEC, INC.

DO NOT SCALE DRAWING

SHEET SCALE: 2:1

SAMTEC

520 PARK EAST BLVD, NEW ALBANY, IN 47150
* PHONE: 812.944.6733 FAX: 812.948.5047
e-Mail: INFO@SAMTEC.COM CODE: 55322

DESCRIPTION:
.8mm DIFFERENTIAL PAIRS HS TERMINAL ASSEMBLY

DWG. NO.
QTE-XXX-XX-X-D-DP-XX

BY: DEAN P 4/28/2000 SHEET 2 OF 4

TABLE 4						MATED HEIGHT WITH QSE-DP-01
STYLE	"D"	GROUND PLANE	TERMINAL	FILLER BODY	SPACER BODY	
-04	.600[15.24]	T-1G1-04-X	T-1S41-04-X	QTE-20-03-D-XX	QTEH-20-01-D-XX-X	.630 [16.00] REF
-05	.718[18.237]	T-1G1-05-X	T-1S41-05-X	QTE-20-03-D-XX	QTEH-20-01-D-XX-X	.748 [19.00] REF
-06	.835[21.209]	T-1G1-06-X	T-1S41-06-X	QTE-20-03-D-XX	QTEH-20-02-D-XX-X	.866 [22.00] REF
-07	.954[24.232]	T-1G17-01-X	T-1S61-01-X	QTEH-20-04-D-XX-X	QTE-20-02-D-XX-X	.984 [25.00] REF
-08	1.151[29.24]	T-1G17-02-X	T-1S54-02-X	QTEH-20-04-D-XX-X	QTE-20-02-D-XX-X	1.181 [30.00] REF
-09	.522[13.259]	T-1G1-09-X	T-1S60-09-x	QTEH-20-01-D-XX-X	QTE-20-02-D-XX-X	.551[14.00] REF
-10	.5606[14.239]	T-1G1-10-X	T-1S60-10-x	QTEH-20-01-D-XX-X	QTE-20-02-D-XX-X	.591[15.00] REF

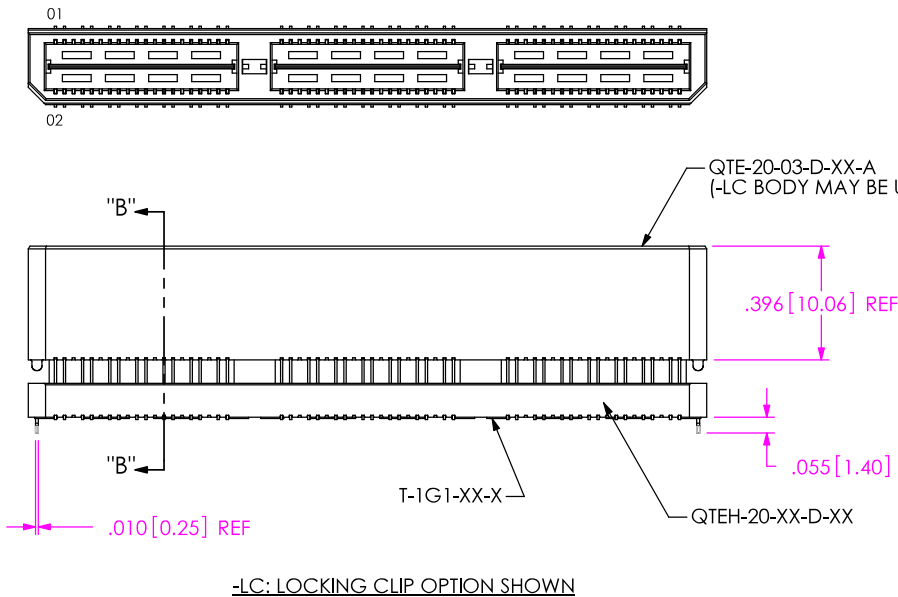

FIG. 4
QTE-042-04-X-D-DP-LC SHOWN
(SAME AS FIG. 1, UNLESS OTHERWISE STATED)
(STYLES -04, -05, & -06)

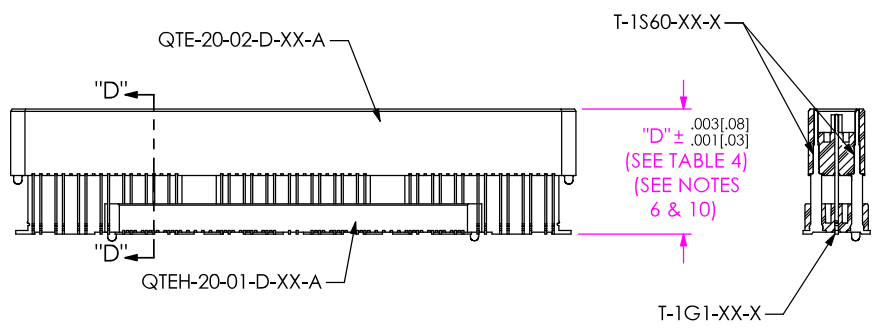
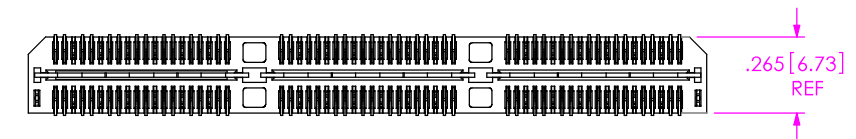
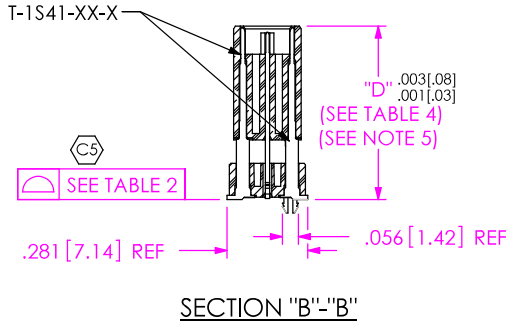

FIG. 6
QTE-042-09-X-D-DP-A SHOWN
(DIFFERENT AS SHOWN, OTHERWISE SAME AS FIG. 4)
(STYLES -09 & -10)

SECTION "D"-"D"
SCALE 1.25 : 1

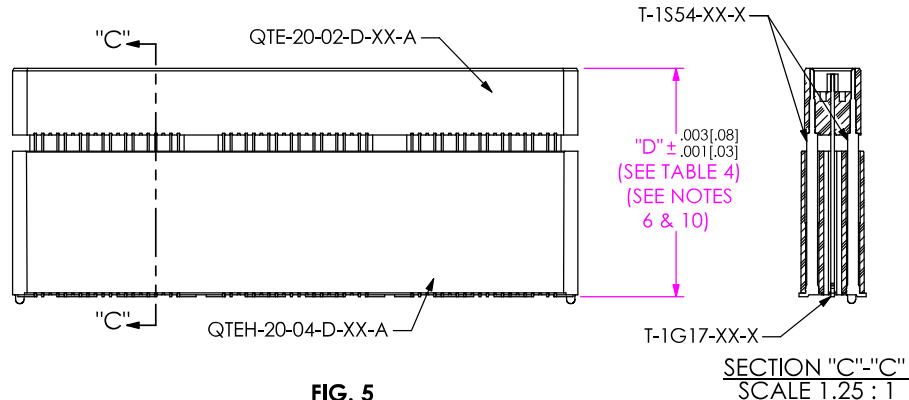

FIG. 5
QTE-042-07-X-D-DP-A SHOWN
(DIFFERENT AS SHOWN, OTHERWISE SAME AS FIG. 4)
(STYLES -07 & -08)

F:\DWG\MISC\MKTG\QTE-XXX-XX-X-D-DP-XX-MKT.SLDDRW

PROPRIETARY NOTE
THIS DOCUMENT CONTAINS INFORMATION CONFIDENTIAL AND PROPRIETARY TO SAMTEC, INC. AND SHALL NOT BE REPRODUCED OR TRANSFERRED TO OTHER DOCUMENTS OR DISCLOSED TO OTHERS OR USED FOR ANY PURPOSE OTHER THAN THAT WHICH IT WAS OBTAINED WITHOUT THE EXPRESSED WRITTEN CONSENT OF SAMTEC, INC.

SAMTEC

520 PARK EAST BLVD, NEW ALBANY, IN 47150
* PHONE: 812.944.6733 FAX: 812.948.5047
e-Mail: INFO@SAMTEC.COM CODE: 55322

DO NOT SCALE DRAWING

SHEET SCALE: 1.5:1

DESCRIPTION:
.8mm DIFFERENTIAL PAIRS HS TERMINAL ASSEMBLY

DWG. NO.
QTE-XXX-XX-X-D-DP-XX

BY: DEAN P 4/28/2000 SHEET 3 OF 4

W

FIG. 7

-RT1: RETENTION OPTION
 (ONLY AVAILABLE ON -01 LEAD STYLE)(MUST USE -A OPTION)
 (NOT AVAILABLE WITH -LC, -GP, -SD, OR -FL OPTIONS)
 (NOT AVAILABLE ON -056 & -070 POSITIONS)
 (SAME AS FIG. 1, UNLESS OTHERWISE STATED)

W

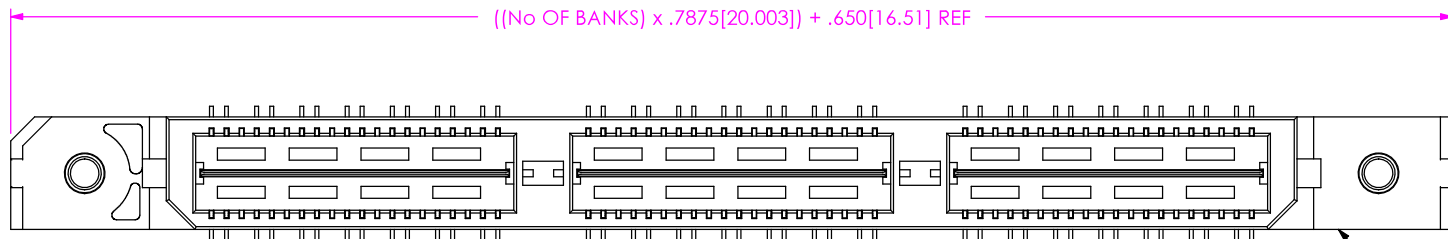

QTE-20-01-D-XX-A-RT1

C6

W

(((No OF BANKS) x .7875[20.003]) + .341[8.66]) ±.004[0.10]

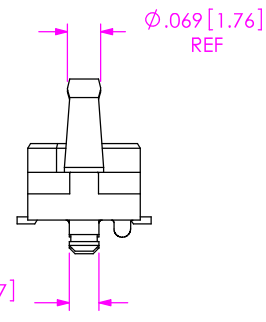
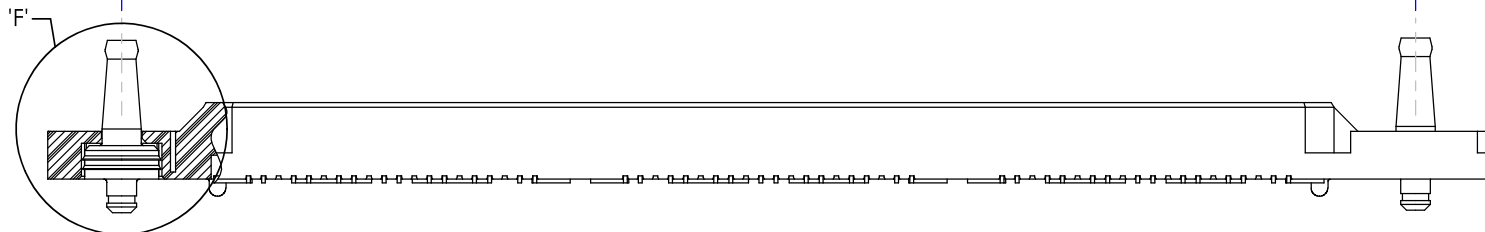

T-1R36-01-F (2X)

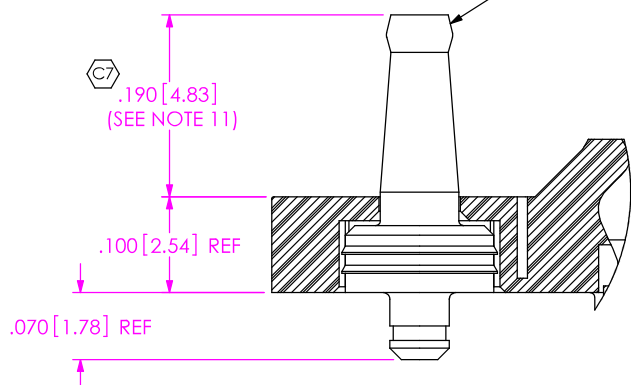

DETAIL 'F'
 SCALE 5 : 1

PROPRIETARY NOTE

THIS DOCUMENT CONTAINS INFORMATION CONFIDENTIAL AND PROPRIETARY TO SAMTEC, INC. AND SHALL NOT BE REPRODUCED OR TRANSFERRED TO OTHER DOCUMENTS OR DISCLOSED TO OTHERS OR USED FOR ANY PURPOSE OTHER THAN THAT WHICH IT WAS OBTAINED WITHOUT THE EXPRESSED WRITTEN CONSENT OF SAMTEC, INC.

DO NOT SCALE DRAWING

SHEET SCALE: 1:0.4

SAMTEC

520 Park East Blvd. New Albany, IN 47151
 Phone (812) 944-6733 Fax (812) 948-5047
 e-Mail: INFO@SAMTEC.COM CODE: 55322

DESCRIPTION:
 .8mm DIFFERENTIAL PAIRS HS TERMINAL ASSEMBLY

DWG. NO. **QTE-XXX-XX-X-D-DP-XX**

BY: DEAN P 4/28/2000 SHEET 4 OF 4