

## 1.Features

- $V_{DS(V)}=60V$
- $I_D=35A(V_{GS}=10V)$
- $R_{DS(ON)}<25m\Omega(V_{GS}=10V)$
- $R_{DS(ON)}<30m\Omega(V_{GS}=4.5V)$

## 2.Product Summary

- TrenchFET<sup>®</sup> Power MOSFET
- 175°C Junction Temperature

## 3.Pinning information

Pin	Symbol	Description
1	G	GATE
2	D	SOURCE
3	S	DRAIN

TO-252(DPAK)  
top view

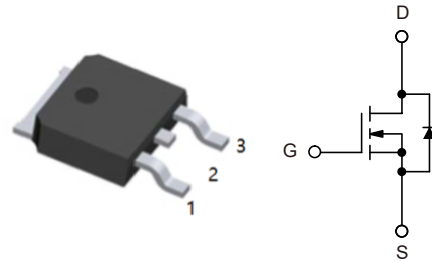

## 4.Absolute Maximum Ratings $T_C= 25^{\circ}C$

Parameter		Symbol	Value	Units
Gate-Source Voltage		$V_{GS}$	$\pm 20$	V
Continuous Drain Current ( $T_J=150^{\circ}C$ ) <sup>b</sup>	$T_C=25^{\circ}C$	$I_D$	35	A
	$T_C=100^{\circ}C$		28	
Pulsed Drain Current		$I_{DM}$	100	
Continuous Source Current (Diode Conduction)		$I_S$	23	
Avalanche Current		$I_{AS}$	20	
Single Avalanche Energy (Duty Cycle $\leq 1\%$ )	$L=0.1mH$	$E_{AS}$	20	mJ
Maximum Power Dissipation	$T_C=25^{\circ}C$	$P_D$	100	W
	$T_A=25^{\circ}C$		$3^a$	W
Storage Temperature Range		$T_J, T_{STG}$	-55 to 175	$^{\circ}C$



## 5. Thermal resistance rating

Parameter		Symbol	Typ	Max	Units
Maximum Junction-to-Ambient <sup>a</sup>	t ≤ 10 sec	R <sub>thJA</sub>	18	22	°C/W
	Steady State		40	50	°C/W
Maximum Junction-to-Case		R <sub>thJC</sub>	3.2	4	°C/W

Notes:

a. Surface Mounted on 1" x 1" FR4 board, t ≤ 10 sec.



## 6.SPECIFICATIONS (T<sub>J</sub>= 25°C, unless otherwise noted)

Parameter	Symbol	Conditions	Min	Typ	Max	Units
<b>Static</b>						
Drain-Source Breakdown Voltage	V <sub>(BR)DSS</sub>	V <sub>GS</sub> =0V, I <sub>D</sub> =250μA	60			V
Gate Threshold Voltage	V <sub>GS(th)</sub>	V <sub>DS</sub> =V <sub>GS</sub> , I <sub>D</sub> =250μA	1	2	3	V
Gate-Body Leakage	I <sub>GSS</sub>	V <sub>GS</sub> =±20V, V <sub>DS</sub> =0V			±100	nA
Zero gate voltage drain current	I <sub>DSS</sub>	V <sub>DS</sub> =60V, V <sub>GS</sub> =0V			1	μA
		V <sub>DS</sub> =60V, V <sub>GS</sub> =0V, T <sub>J</sub> =125°C			50	μA
		V <sub>DS</sub> =60V, V <sub>GS</sub> =0V, T <sub>J</sub> =175°C			250	μA
On-State Drain Current <sup>b</sup>	I <sub>D(ON)</sub>	V <sub>DS</sub> =5V, V <sub>GS</sub> =10V	50			A
Drain-Source On-State Resistance <sup>b</sup>	R <sub>DS(ON)</sub>	V <sub>GS</sub> =10V, I <sub>D</sub> =15A		25	31	mΩ
		V <sub>GS</sub> =4.5V, I <sub>D</sub> =10A		30	45	mΩ
Forward Transconductance <sup>b</sup>	g <sub>FS</sub>	V <sub>DS</sub> =15V, I <sub>D</sub> =15A		20		S
<b>Dynamic<sup>a</sup></b>						
Input Capacitance	C <sub>iss</sub>	V <sub>GS</sub> =0V, V <sub>DS</sub> =25V, f=1MHz		670		pF
Output Capacitance	C <sub>oss</sub>			140		pF
Reverse Transfer Capacitance	C <sub>rss</sub>			60		pF
Total Gate Charge <sup>c</sup>	Q <sub>g</sub>	V <sub>DS</sub> =30V, V <sub>GS</sub> =10V, I <sub>D</sub> =23A		11	17	nC
Gate-Source Charge <sup>c</sup>	Q <sub>gs</sub>			3		nC
Gate-Drain Charge <sup>c</sup>	Q <sub>gd</sub>			3		nC
Turn-On Delay Time <sup>c</sup>	t <sub>D(on)</sub>	V <sub>DD</sub> =30V, R <sub>L</sub> =1.3Ω I <sub>D</sub> ≈ 23A, V <sub>GEN</sub> =10V, R <sub>G</sub> =2.5Ω		8	15	ns
Rise Time <sup>c</sup>	t <sub>r</sub>			15	25	ns
Turn-Off Delay Time <sup>c</sup>	t <sub>D(off)</sub>			30	45	ns
Fall Time <sup>c</sup>	t <sub>f</sub>			25	40	ns



Source-Drain Diode Ratings and Characteristics $T_c=25^\circ\text{C}$						
Pulsed Current	$I_{SM}$				50	A
Diode Forward Voltage	$V_{SD}$	$I_F=15\text{A}, V_{GS}=0\text{V}$		1	1.5	V
Reverse Recovery Time	$t_{rr}$	$I_F=15\text{A}, di/dt=100\text{A}/\mu\text{s}$		30	60	ns

## Notes:

- For design aid only; not subject to production testing.
- Pulse test; pulse width  $\leq 300\mu\text{s}$ , duty cycle  $\leq 2\%$ .
- Independent of operating temperature.



## 7.1 Typical Characteristics

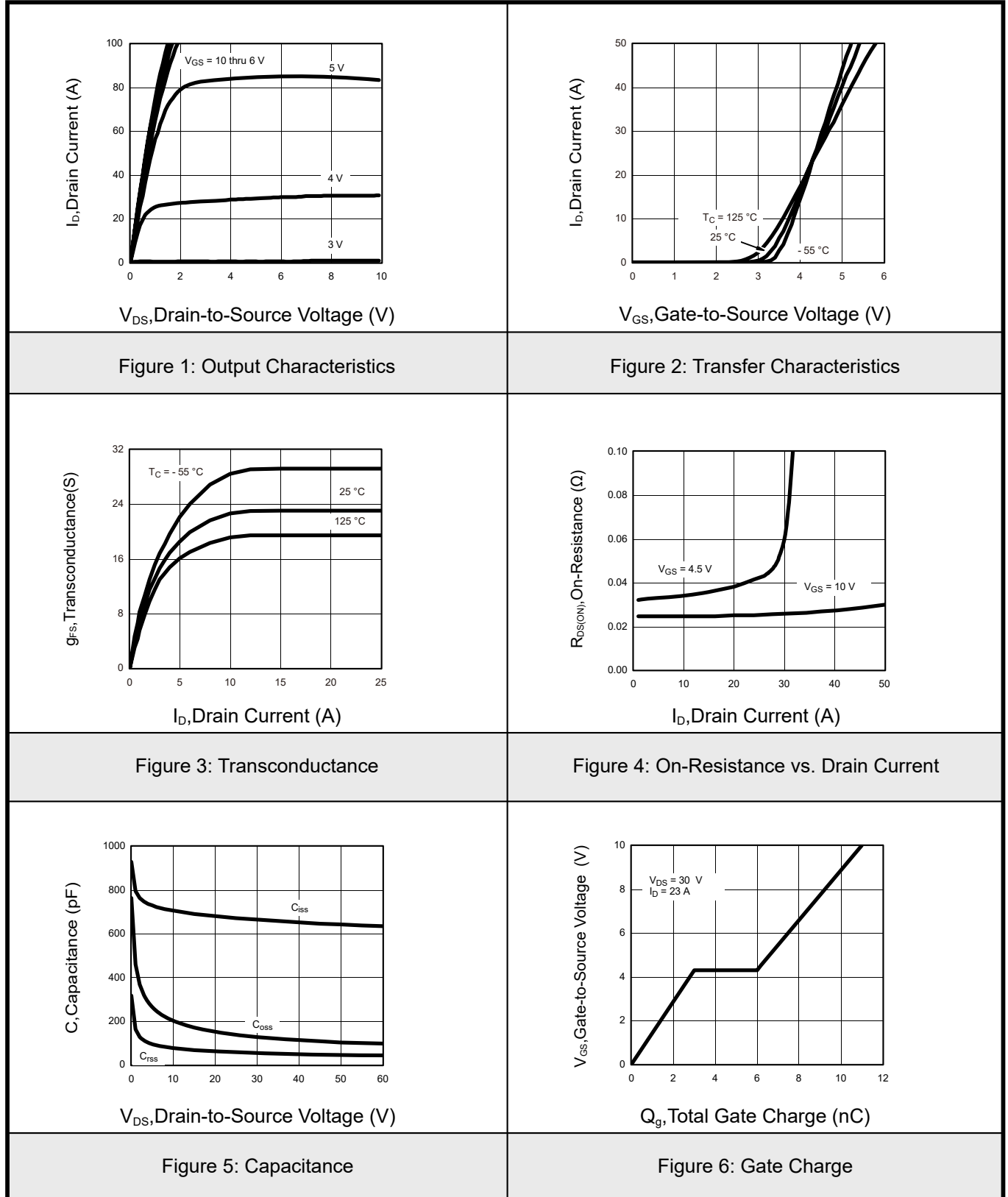



## 7.2 Typical Characteristics

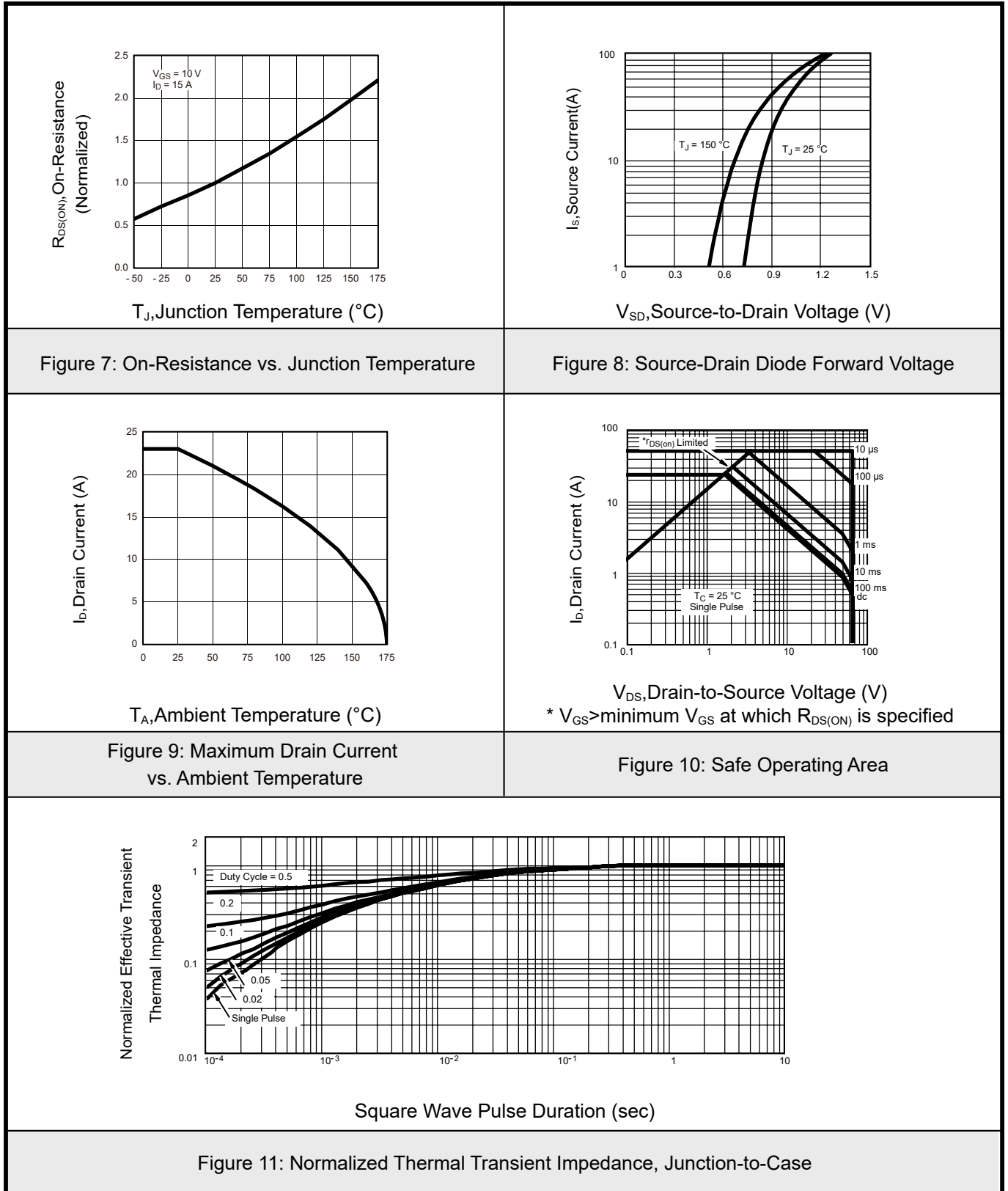



## 8.TO-252 Package Outline Dimensions

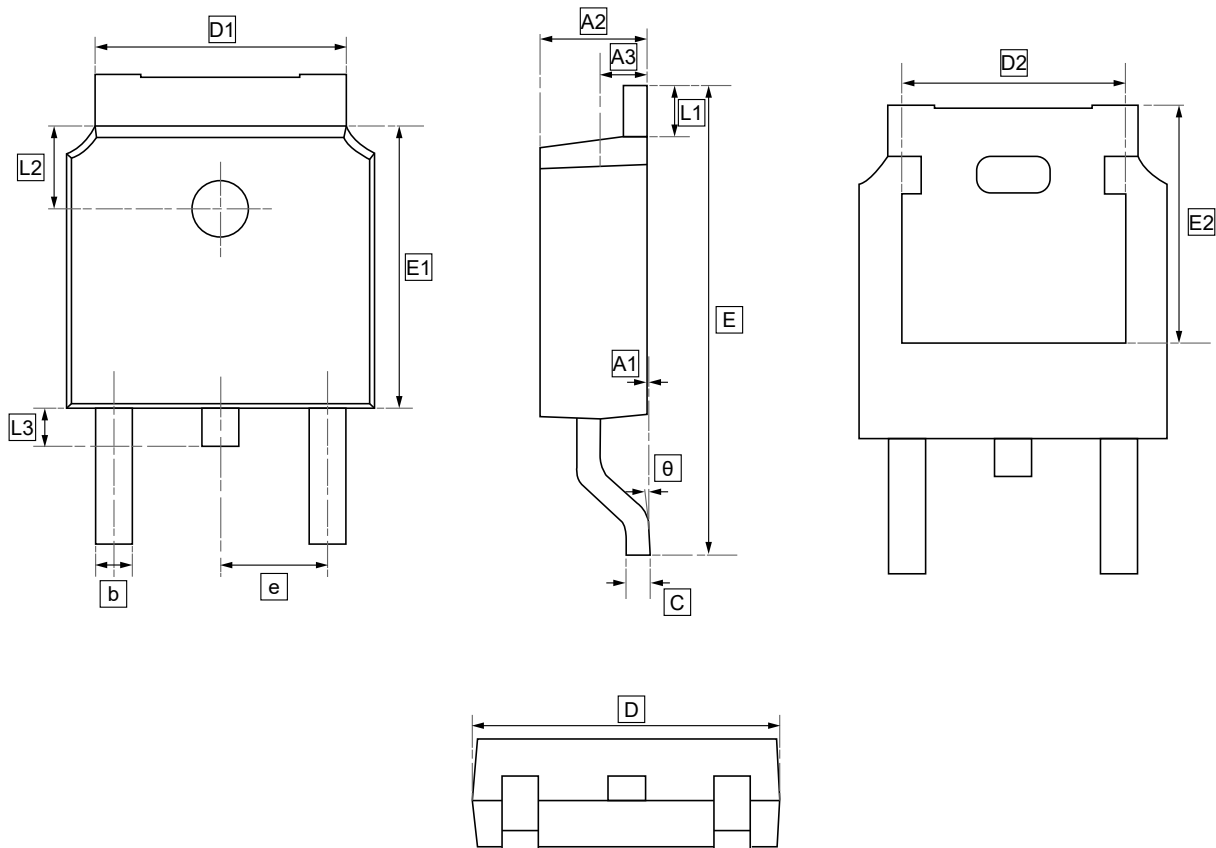

### DIMENSIONS (mm are the original dimensions)

Symbol	A1	A2	A3	b	c	D	D1	D2	E	E1	E2	e	L1	L2	L3	$\theta$
<b>Min</b>	0.00	2.18	0.90	0.65	0.46	6.35	4.95	4.32	9.40	5.97	5.21	2.286	0.89	1.70	0.60	0.00
<b>Max</b>	0.13	2.39	1.10	0.85	0.61	6.73	5.46	4.90	10.41	6.22	5.38	BSC	1.27	1.90	1.00	8.00



## 9. Ordering information

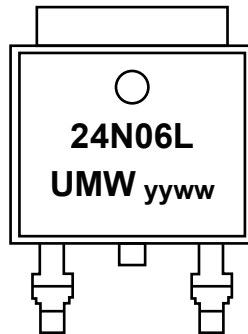

yy: Year Code  
ww: Week Code

Order Code	Package	Base QTY	Delivery Mode
UMW NTD24N06LT4G	TO-252	2500	Tape and reel



## 10.Disclaimer

---

UMW reserves the right to make changes to all products, specifications. Customers should obtain the latest version of product documentation and verify the completeness and currency of the information before placing an order.

When applying our products, please do not exceed the maximum rated values, as this may affect the reliability of the entire system. Under certain conditions, any semiconductor product may experience faults or failures. Buyers are responsible for adhering to safety standards and implementing safety measures during system design, prototyping, and manufacturing when using our products to prevent potential failure risks that could lead to personal injury or property damage.

Unless explicitly stated in writing, UMW products are not intended for use in medical, life-saving, or life-sustaining applications, nor for any other applications where product failure could result in personal injury or death. If customers use or sell the product for such applications without explicit authorization, they assume all associated risks.

When reselling, applying, or exporting, please comply with export control laws and regulations of China, the United States, the United Kingdom, the European Union, and other relevant countries, regions, and international organizations.

This document and any actions by UMW do not grant any intellectual property rights, whether express or implied, by estoppel or otherwise. The product names and marks mentioned herein may be trademarks of their respective owners.