

2.00±0.15(PITCH)

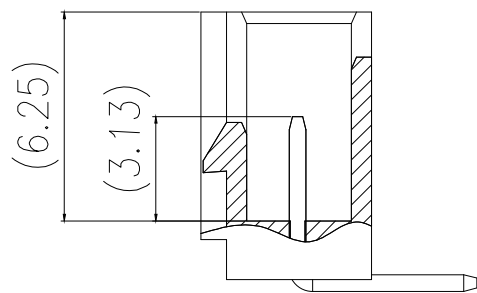
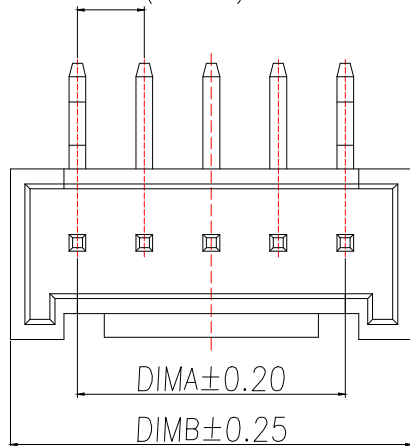

SECTION A-A

Technical Index:

1. Temperature range: $-40^{\circ}\text{C}\sim 85^{\circ}\text{C}$.
2. Rated voltage: 200V DC/AC(rms).
3. Rated current: 2.0A.
4. Contact resistance: $\leq 25\text{m}\Omega$.
5. Withstanding voltage: 500V AC/minute.
6. Insulation resistance: $\geq 1000\text{M}\Omega$.

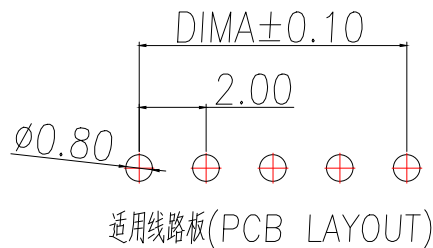
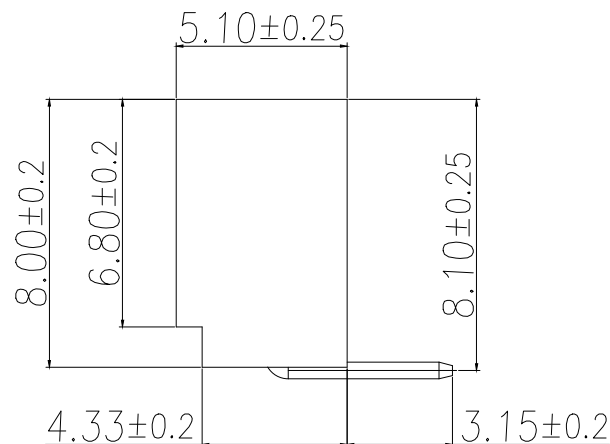
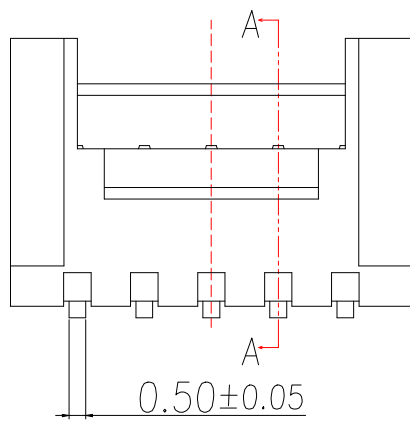

Part No	Pin	A	B
BX-HY2.0-2PWZ-R	2	2.00	6.00
BX-HY2.0-3PWZ-R	3	4.00	8.00
BX-HY2.0-4PWZ-R	4	6.00	10.00
BX-HY2.0-5PWZ-R	5	8.00	12.00
BX-HY2.0-6PWZ-R	6	10.00	14.00
BX-HY2.0-7PWZ-R	7	12.00	16.00
BX-HY2.0-8PWZ-R	8	14.00	18.00
BX-HY2.0-9PWZ-R	9	16.00	20.00
BX-HY2.0-10PWZ-R	10	18.00	22.00
BX-HY2.0-11PWZ-R	11	20.00	24.00
BX-HY2.0-12PWZ-R	12	22.00	26.00
BX-HY2.0-13PWZ-R	13	24.00	28.00
BX-HY2.0-14PWZ-R	14	26.00	30.00
BX-HY2.0-15PWZ-R	15	28.00	32.00
BX-HY2.0-16PWZ-R	16	30.00	34.00
BX-HY2.0-17PWZ-R	17	32.00	36.00
BX-HY2.0-18PWZ-R	18	34.00	38.00
BX-HY2.0-19PWZ-R	19	36.00	40.00
BX-HY2.0-20PWZ-R	20	38.00	42.00

序号	品名	材质	制图 DRAWN	变更内容 DESCRIPTION	日期 DATE	GENERAL TOLERANCE		制图 DRAWING	EMMA	料号 PART NO.	BX-HY2.0-NPWZ-R	版本 REV.	A
						X.±0.50	X'.:±5'						
1	HY2.0 弯针 胶芯	PA66 UL94V-2 Red				.X±0.20	X.X':±3'	核准 APPROVAL	JADE	客户料号 CUTM.NO.			
2	HY2.0 弯针 端子	Copper Alloy/ Tin Plating				.XX±0.10	X.XX':±1'	单位 UNITS	MM	比例 SCALE	1:1		