

申明: 凡是没有产品料号或有“PRELIMINARY”标识的产品图均为临时图面暂不能生产/DECLARATION: ALL PRODUCT DRAWINGS WITHOUT THE PART NUMBER OR WITH “PRELIMINARY” LABEL ARE TEMPORARY DRAWINGS CAN NOT BE PRODUCED

REV.	ECN NO.	DESCRIPTION	DATE	DESIGN
B	ECN NO.	UPDATE THE DRAWING	2019.05.25	Yuxiaobin
C	ECN NO.	UPDATE THE DRAWING	2020.04.30	SYJ

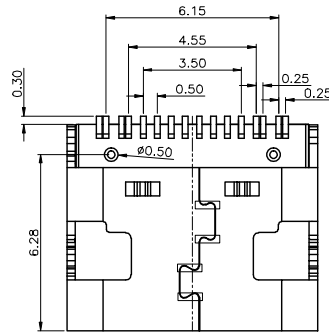
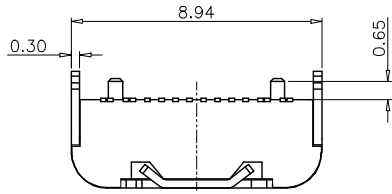

NOTE:

1.MATERIAL SPECIFICATION:

- 1.HOUSING:LCP E130i
- 2.TERMINAL: COPPER ALLOY(C2680)
- 3.FRONT SHELL: STAINLESS STEEL(SUS201)

2.PLATING SPECIFICATION:

2-1.TERMINAL:

Ni 50u" MIN. UNDER PLATED OVER ALL.  
Au PLATED ON THE FUNCTIONAL AREA OF CONTACT.  
(GOLD PLATING THICKNESS FOLLOW THE P/N)

PLATING SPECIFICATIONS OF THE SOLDER AREA FOLLOW THE P/N

2-2.FRONT SHELL:

PLATING SPECIFICATIONS FOLLOW THE P/N

2-3.MID PLATE:

CLEAR ONLY

3.MECHANICAL PERFORMANCE,

- 3-1.INSERTION FORCE: 0.5~1.2kgf.
- 3-2.REMOVAL FORCE: 0.6kgf~1.5kgf.
- 3-3.DURABILITY: 5000 CYCLES.

4.ELECTRICAL PERFORMANCE,

- 4-1. VOLTAGE RATING:5 V DC/AC (RMS. max)  
CURRENT RATING:3 AMPS. FOR TOTAL VBUS/GND PINS;  
1.25AMPS FOR CC PIN,0.25 AMPS. FOR ALL OTHER CONTACT.

4-2. LLCR:

VBUS & GND PINS AND OTHER PINS: 40mΩ/PIN MAX.  
SHIELD: 50mΩ/MAX.  
LLCR MAX. CHANGE OF ALL PINS: 10mΩ.

4-3.INSULATION RESISTANCE: 100MΩ MIN

4-4.DIELECTRIC WITHSTAND VOLTAGE,AC 100V FOR 1 MINUTE.

5. ENVIRONMENTAL PERFORMANCE:

OPERATING TEMPERATURE: -25°C~+85°C.

6.IR REFLOW:

THE PEAK TEMPERATURE ON THE BOARD SHALL  
BE MAINTAINED FOR 10 SECONDS AT 260°C.

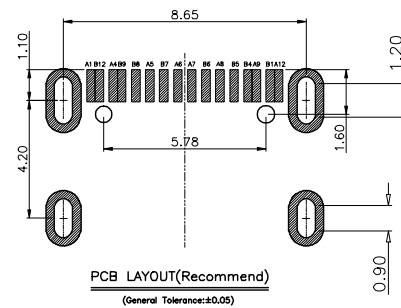
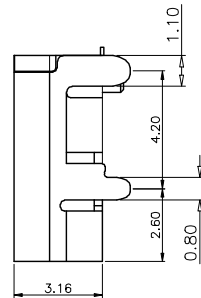
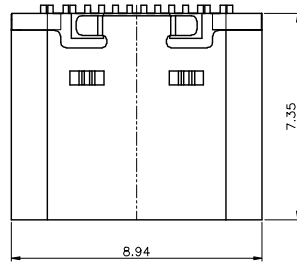

PCB LAYOUT(Recommend)  
(General Tolerance:±0.05)

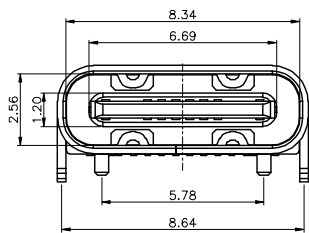

USB TYPE-C PIN ASSIGNMENTS

PIN NUMBER	SIGNAL NAME	PIN NUMBER	SIGNAL NAME
A1	GND	B12	GND
A4	VBUS	B9	VBUS
A5	CC1	B8	SBU2
A6	Dp1	B7	Dn2
A7	Dn1	B6	Dp2
A8	SBU1	B5	CC2
A9	VBUS	B4	VBUS
A12	GND	B1	GND

TOLERANCE		NAME(INTENDED USE) CUSTOMER DRAWING	浙江创都电子科技		
X.X ±0.30	X.' ±10'	PART NO.	TITLE: TYPE-C-16PBS-3MD		
.XX ±0.20	.X' ± 8'		DRAWG NO.		
.XXX ±0.10	.XX' ± 5'	DESIGN: DRAW	SCALE		
UNITS	mm	CHED:	SHEET		
MATERILA		APPD:	REV.		
FINISH			SCALE	SHEET	REV.