

RoHS

SPECIFICATIONS

Rated Current:1.0AMP
 Contact Resistance:20mΩ Max
 Withstand Voltage:500V AC/DC
 Insulation Resistance:1000MΩ Min
 Operation Temperature:-40°C to +105°C

Contact Material:Brass
 Contact Plating:Au or Sn Over Ni
 Insulator Material:Polyester(UL94V-0)
 Standard: PA6T
 Max.Processing Temp: 230°C for 30-60 seconds
 (260°C for 10 seconds)

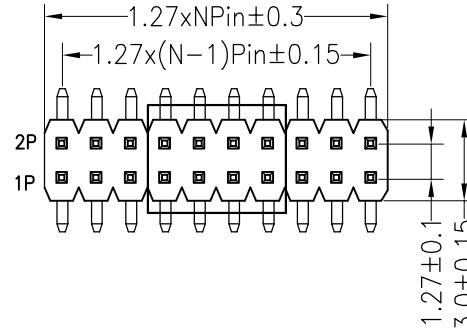

Recommended P.C.B Layout(Top Side)
 (PCB BOARD TOLERANCE±0.05)

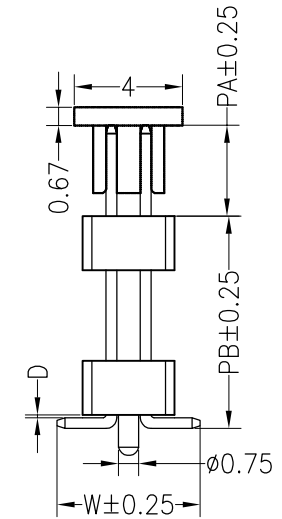
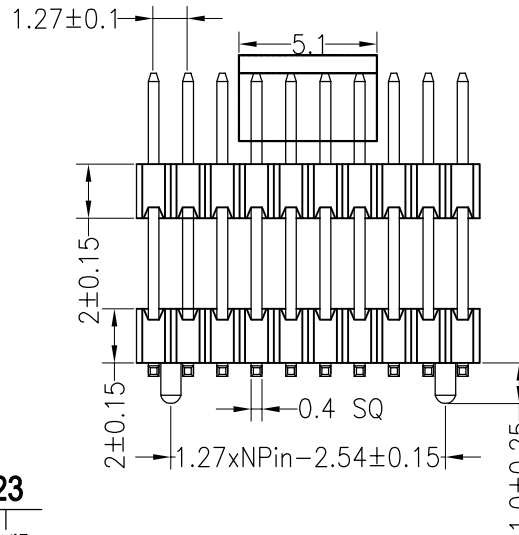
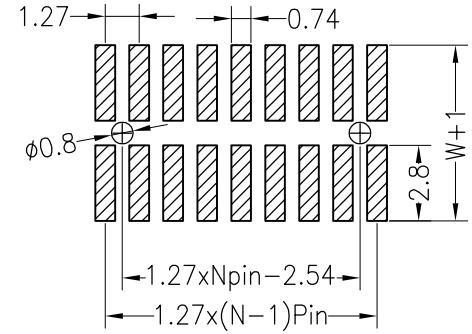

Ordering Information

P	1	C	2	04	3	5	00	2	1623
产品类型 P=排针	间距 1=1.27	塑胶高度 C=2.0	排数 2=双排	单排PIN数 1~40P	产品形态 3=SMT	塑胶材料 5=PA6T	电镀厚度 00=常规 01=1u" 02=2u" 03=3u"	包装方式 1=管装 2=卷装 3=盒装 4=袋装 5=盒装	序列号

Dimension antitheses list					
ITEM	PA	PB	W	D	L
Alternate	2.45	4.7	5.50	0.10	8.9

深圳市连盛精密连接器有限公司

				OPERATION		DRAW		SCALE		FIT	
				X.X	±0.30						
				X.XX	±0.20	CHECK					
				X.XXX	±0.10						
A0	2012.04.19	NEW DRAWING		Angle	±3°	APPROVE					
REV	DATE	MODIFICATION DESCRIPTION		DIM	TOL						

PART NO.	1010100178
TITLE:	1.27PH 2H=2X2.0 2*4P SMT=5.5 PA2.45 PB4.7 L=8.9 AU0.8U PA6T 带柱φ0.75 H1.0 加盖卷装