

GT-TA205X-HXXX-LX

G-SWITCH

Operating Force

A=180gf
B=250gf
C=100gf
D=360gf

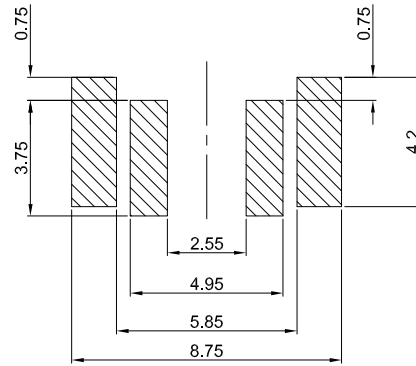
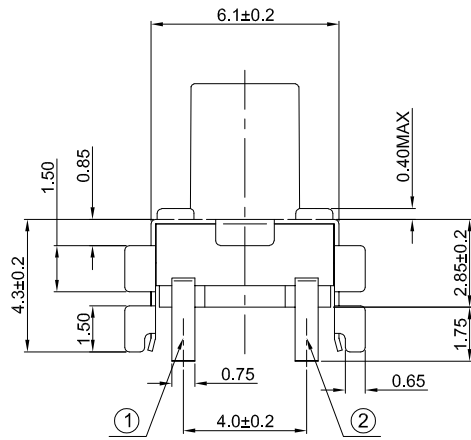

P.C.B LAND DIMENSION

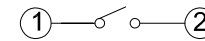

CIRCUIT DIAGRAM

Switch Height (mm)

H023=2.3mm
H044=4.4mm

Switch lifetime (Force)

L3=300,000 Cycles
L5=500,000 Cycles

G-Switch Specification:

1. Operating temperature range: -40°C to +85°C
2. Rating: 50mA, 12V DC
3. Insulation resistance: 100MΩ min., 100V DC
4. Dielectric strength: 250V AC for 1 min
5. Contact resistance: 100mΩ max.
6. Travel: 0.3±0.1mm
7. Water Resistance: IPX7

7	STEM	1	PPA	White
6	COVER	1	SUS	Ag plating
5	PRESS PAD	1	PPA	
4	DUST PAD	1	RUBBER	
3	CONTACT FORM	1	SUS	Ag plating
2	TERMINAL	1	H65	Ag plating
1	BASE	1	PA6T	
NO.	PART NAME	QTY	MATERIAL	REMARK

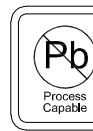

RoHS
Compliant
2002/95/EC



SCALE: 4:1 UNIT: mm
SIZE: A4

Unless otherwise
General Tolerance:
X. ±0.30
X.x ±0.20
X.xx ±0.15
X.xxx ±0.10
Angles ±3°

Title: Horizontal Tact Switch 6.3×6.2×Hmm
Smt Bracket Type IPX7

Molde Code: GT-TA205X-HXXX-LX

DRAWN	CHECKED	APPROVED	DATE
Xia	Chen	Chen	2022.11.01



REV: A0 SHEET: 1/1