

SPECIFICATIONS

Rated Current: 3.0AMP
 Contact Resistance: 20mΩ Max
 Withstand Voltage: 1000V AC/DC
 Insulation Resistance: 1000MΩ Min
 Operation Temperature: -40°C to +105°C

Contact Material: Copper Alloy
 Contact Plating: Au Or Sn Over Ni
 Insulator Material: Polyester(UL94V-0)
 Resistance To Soldering Heat:
 245°C±5°C, 10s(PBT insulator)
 260°C±5°C, 10s(PA6T&PA9T&LCP insulator)

Ordering Information

2285 02 XX X N XX S Y X XX

No. of Pins Per Row 02~40P	Insulator Material Option A=BK-PBT C=BK-PA6T E=BK-PA9T F=BK-LCP	Contact Plating G1:Gold Flash G2:1.5u" Gold G3:2u" Gold G4:3u" Gold G5:5u" Gold G6:10u" Gold G7:15u" Gold G8:30u" Gold S0:Gold Flash/Tin SN:tin	Packing A=Troy T=Tube	code stream 01~99
-------------------------------	-----------------------------------------------------------------------------	-------------------------------------------------------------------------------------------------------------------------------------------------------------------------------	-----------------------------	----------------------

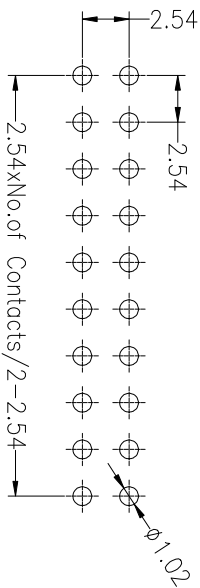
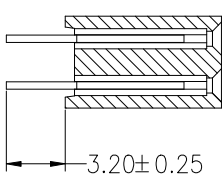
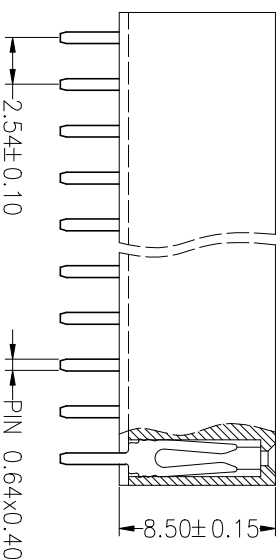
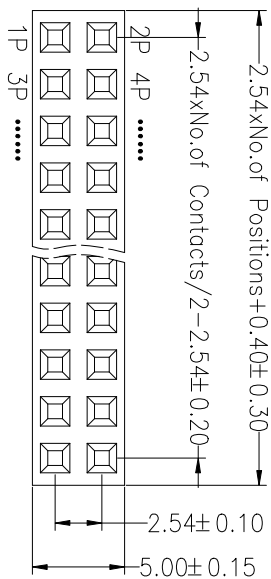

Recommended P.C.B Layout(Top Side)
 (PCB BOARD TOLERANCE±0.05)

OPERATION		DRAW		RICH LIN		SCALE		FIT		PART NO.	
X.X	±0.30	X.X	±0.20	X.XXX	±0.10	Angle	±3°	DIM	TOL	APPROVE	
DATE		MODIFICATION DESCRIPTION		CHANGE		DIM		TOL		CHANGE	
A0		2012.11.14		NEW DRAWING							
REV		DATE		MODIFICATION DESCRIPTION		CHANGE		DIM		TOL	
1		2		3		4		5		6	
A		B		C		D		E		F	
A		B		C		D		E		F	
A		B		C		D		E		F	

JILIN 深圳锦凌电子股份有限公司
 SHENZHEN JINLING ELECTRONICS CO.,LTD
 Tel: 86-755-27483253 Fax: 86-755-2997-5588

228502XXXXXXSYXXX
 2.54PF H8.5mm 2xNpin 180°