

承 认 书
SPECIFICATION FOR APPROVAL

客 户 Customer:

产品名称 Project:

SMA天线连接器

规格型号 Part No:

SMA-KE-Z

贵公司承认印 Approval signatures

料 号/Part No.	签 章/Signatures

日期 Date:

拟制/Drawn	王宗华	
审核/Check	陈森森	
批准/Approved	张春华	

1.1 Specifications

型号 Antennas Type	SMA-KE-Z
阻抗 Impedence (Ω)	50 Ω
电压驻波比 V.S.W.R	直式软性电缆<1.15+0.02f (GHZ)
频率范围 Frequenc Range(MHz)	0-12. 4G(软电缆)
工作电压 DC Voltage (V)	335V max
介质耐压 Withstand Voltage(V)	1000Vrms
接触电阻 Contact resistance()	内导体<3mOhm 外导体<2mOhm
绝缘电阻 Insulation resistance	>5000 兆欧
插入损耗 Insert Loss	0. 15dB(6GHz)
射频泄漏 RF leakage	-60dB/-90dB(软电缆/半刚电缆)@2-3GHz
耐用性 Durability(mating)	500 次
PLUG 内径/JACK 外径	6. 5mm/5. 4mm
壳体 shell	黄铜镀硬金或不锈钢表面钝化
插针 contact pin	黄铜镀硬金
插孔 socket	镀青铜镀硬金
绝缘体 insulator	聚四氟乙烯
密封件 sealing	硅橡胶
压接套 crimp ferrule	铜合金镀镍
重量 Weight(g)	None
工作温度 Operating Temperature($^{\circ}$ C)	-65~+165 (PE CABLE-40~+85)
标准 APPLICABLE STANDARD	MIL-C-39012、IEC169-15、CECC22110

1.2 Antenna Picture



上图型号: SMA-KE-Z

*注: 因天线功能较为敏感, 主体周边机构有变更请通知我们评估。

2. Electrical Specification

2.1 Test Equipment

- A. VSWR and input impedance: Agilent 8753/E5071 Network Analyzer
- B. Antenna gain and efficiency: ETS three-dimensional anechoic chamber

2.2 Test Setup

2.2.1 Frequency Range

2.2.2 VSWR

Step 1: The antenna is arranged on the customer provided test fixture.

Step 2: The VSWR of the antenna is measured via Agilent 8720/8753 Network Analyzer (see figure. 1).



Figure.1

2.2.3 Radiation pattern and Gain

- A. The 3D chamber provides less than -40dB reflectivity from 800MHz to 6GHz and a 40cm diameter spherical quiet zone. The measurement results are calibrated using both dipoles and standard gain horns (see figure. 2).
- B. The antenna under tested is arranged in the turned table and a decoupling sleeve is used to reduce feed line radiation (see figure. 3).
- C. The measured results of the radiation patterns and antenna gain are obtained from the control system and showed on the monitor (see figure. 4 and 5).

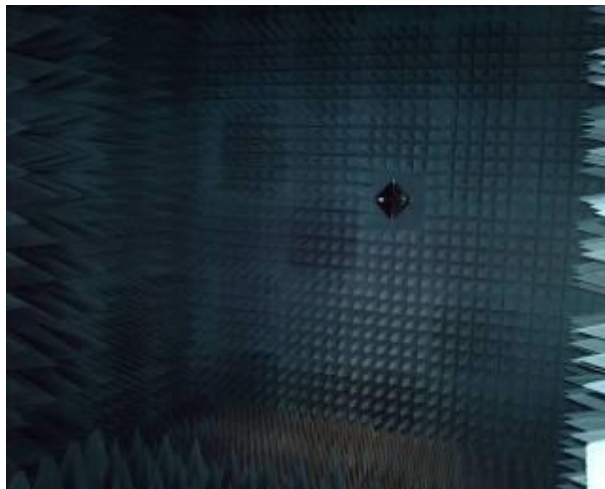

Figure.2



Figure.3

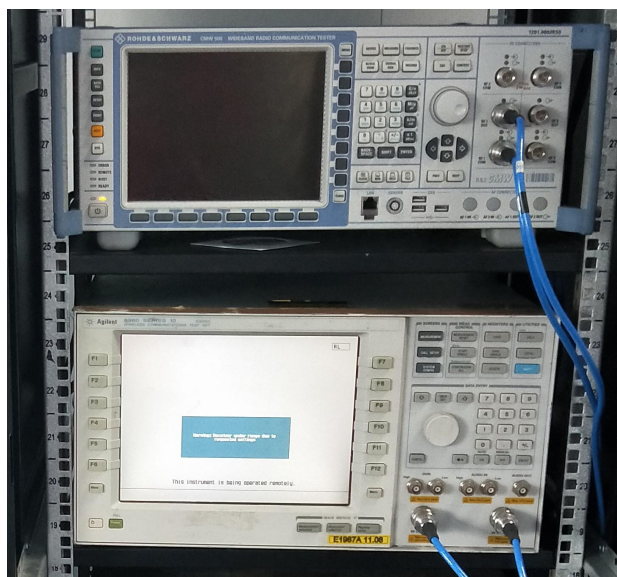

Figure.4

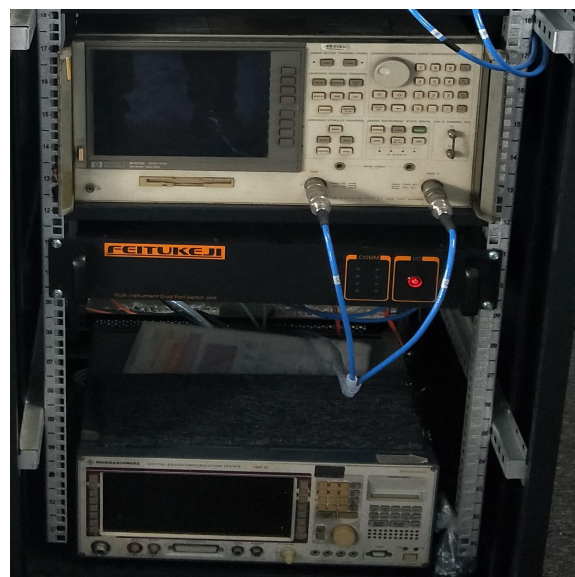
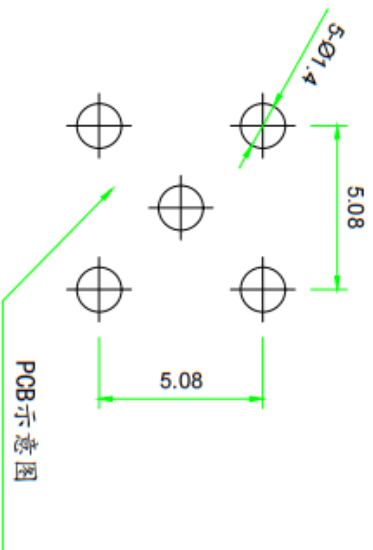
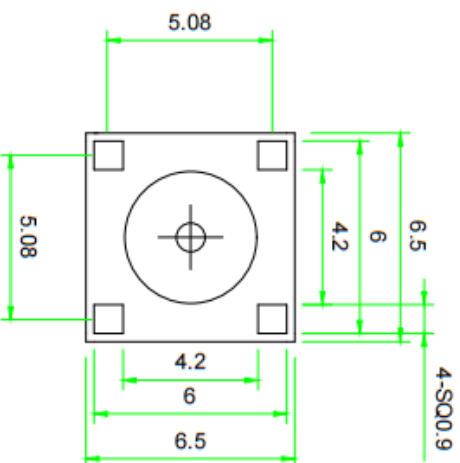
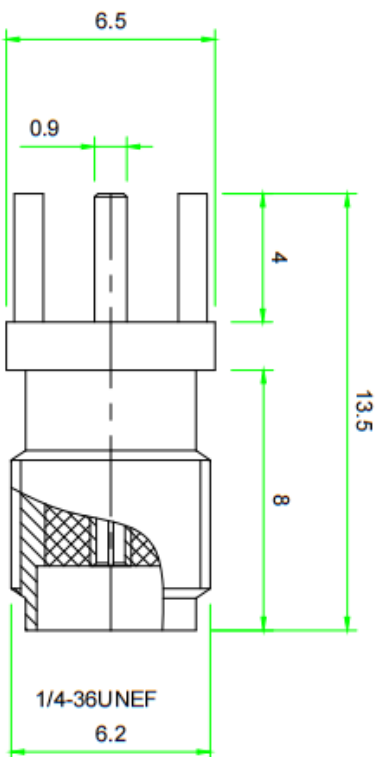

Figure.5



- 材质要求:
1. 壳体: 黄铜镀金
 2. 绝缘体: 聚四氟乙烯 (PTFE)
 3. 插孔: (HPb59-1)
 4. 盐雾 24h

技术要求:

1. 未注公差按±0.2
2. 镀层均匀、光滑、无污渍、刮伤.
3. 材料需符合RoHS要求。

ECN BO.		new		2015/5/3		A		瀚源
DESIGNED		CHECKED		APPROVAL		DESCRIPTION.		
Mikey		Tom		Jerry		SMA-KE-Z		SCALE: 3:1
MODEL NAME		MODEL NAME		UNLESS OTHERWISE SPECIFIED, TOLERANCE:		X X.X X.XX		
3RD ANGLE PROJ		HanElectricity Co., LTD		SCALE: 1/2		X X.X X.XX		±0.25 ±0.20 ±0.15 ±3
FILE NO.								