

PCB REFERENCE DIAGRAM  
TOLERANCE:±0.05

**G-Switch Specification:**

- 1.Current rated: 0.2A AC/DC
2. Voltage rating: 30V AC/DC
- 3.Withstanding voltage: 100V AC for 1 min
- 4.Contact resistance: 100mΩ max.
- 5.Insulation resistance:50MΩ min
- 6.Durability cycle: 20Cycles
- 7.Removal force: 0.015kgf/Pin min
- 8.Operating temperature range: -55°C ~ +85°C

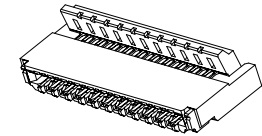
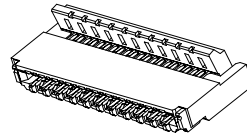

GT-F0302 S R 09 -XX X XX 01

G-Switch

Series No

Termipoint  
S-SMT

Angle  
R-90°

Terminal Plating  
11-G/F

Housing Colour  
S-Nature

Pin Q' PY  
09~71

Height  
09-0.90mm

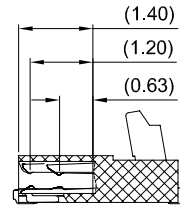
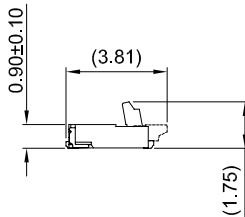
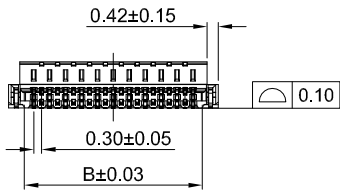

SECTION A-A(2:1)

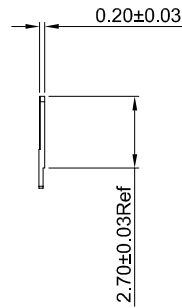
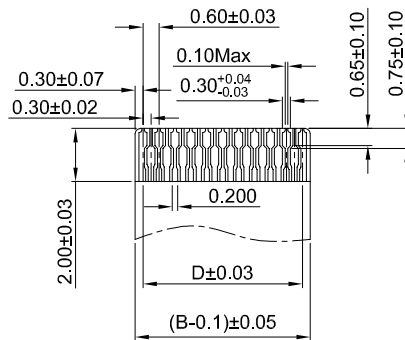
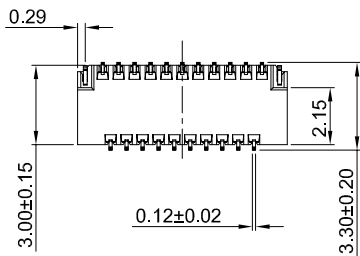

APPLICABLE FPC

**Ordering Information:**

Circuit	Dimensions(mm)				Circuit	Dimensions(mm)			
	A	B	C	D		A	B	C	D
09	4.30	3.10	1.80	2.40	33	11.50	10.30	9.00	9.60
11	4.90	3.70	2.40	3.00	35	12.10	10.90	9.60	10.20
13	5.50	4.30	3.00	3.60	39	13.30	12.10	10.80	11.40
15	6.10	4.90	3.60	4.20	41	13.90	12.70	11.40	12.00
17	6.70	5.50	4.20	4.80	45	15.10	13.90	12.60	13.20
19	7.30	6.10	4.80	5.40	51	16.90	15.70	14.40	15.00
21	7.90	6.70	5.40	6.00	55	18.10	16.90	15.60	16.20
23	8.50	7.30	6.00	6.60	57	18.70	17.50	16.20	16.80
25	9.10	7.90	6.60	7.20	61	19.90	18.70	17.40	18.00
27	9.70	8.50	7.20	7.80	67	21.70	20.50	19.20	19.80
29	10.30	9.10	7.80	8.40	71	22.90	21.70	20.40	21.00
31	10.90	9.70	8.40	9.00	--	--	--	--	--

4	SOLDER TABS	BRASS	MATTE Tin
3	CONTACT	PHOSPHOR BRONZE	ALL G/F
2	COVER	PA9T,94V-0	BLACK
1	HOUSING	LCP,94V-0	BLACK
NO.	PART NAME	MATERIAL	REMARK



SCALE: 1:1 UNIT: mm

SIZE: A4

Unless otherwise  
General Tolerance:  
X ±0.40  
X.x ±0.30  
X.xx ±0.20  
X\* ±5°  
X.X\* ±3°

Title: FPC 0.30mm Pitch 90° SMT Type  
H0.90mm Back Flip Connector

Molde Code: GT-F0302SR09-XXXXX01

DRAWN	CHECKED	APPROVED	DATE
Hu	Hu	Chen	2023.10.20



REV: A0 SHEET: 1/1