

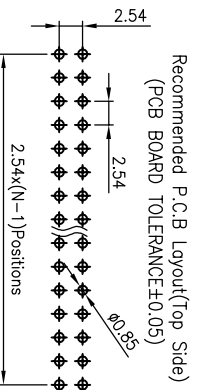

Technical Specs:

Insulator: Black glass filled polyester PPS-GF30-FR
 Flammability: UL 94V-O
 Sleeve: Brass
 Contact clip(4/6 finger): Beryllium copper(C17200)/Phosphor Bronze
 Accepted pin: Ø0.40 to 0.56mm
 Forces:
 --Insertion 2 N typ
 2 N typ
 --Withdrawal 1 N typ
 Mechanical life: min500 cycles
 Rated current: 3A
 Contact resistance: max 10mΩ
 Dielectric resistance: Min 1000V RMS
 Max.Processing Temp:230°C for 30-60 seconds
 (260°C for 10 seconds)

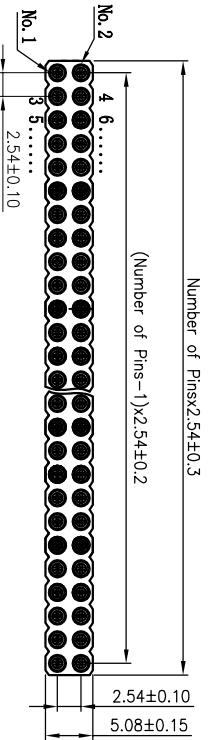
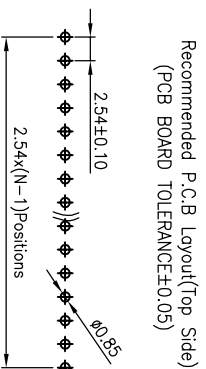
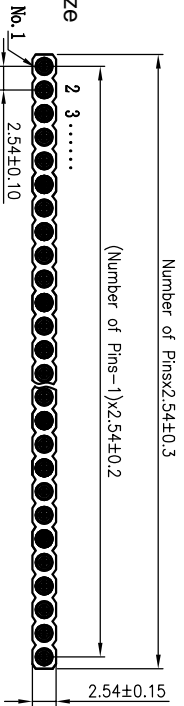

Ordering Information

3620 30 X XX S XX 074 01

Insulator Type
 Code
 1:Single row
 2:Double row
 No.of Pins
 1-40Pin
 Contact Plating
 G0:Gold Flash
 S0:Gold
 S4:5u"Gold/Tin
 S5:10u"Gold/Tin
 S6:30u"Gold/Tin
 Length
 074=7.43mm

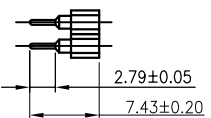
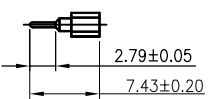
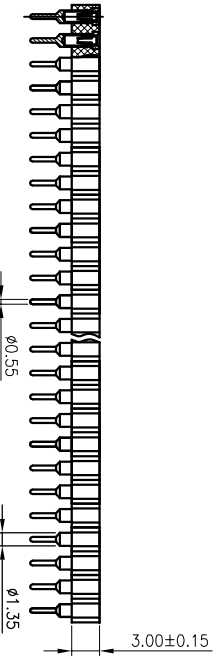

OPERATION		DRAW	JINCHENGXIN	17.08.05
X.X	±0.30			
X.XX	±0.20	CHECK		
X.XXX	±0.10			
Angle	±3°	APPROVE		
DIM	TOL			

SCALE	FIT
UNIT	mm
SIZE	A4
SHEET	1/1
PROL.	

JILIN SHENZHEN JINLING ELECTRONIC CO.,LTD
 深圳市锦凌电子有限公司
 Tel: 86-755-2997-5806/5802 Fax: 86-755-2997-5992
 PART NO. 362030XXXSX07401
 TITLE: 2.54X3.0 圓孔母座 180° L=7.43

REV	DATE	MODIFICATION DESCRIPTION	CHANGE	APPROVE	PROL.	TITLE
A0	2017.08.05	NEW DRAWING				2.54X3.0 圓孔母座 180° L=7.43
1						