

REV.	ECR/N NO./DESCRIPTION	DATE	DRAWN	CHECKED	APPROVE
A	RD14008	05/16'14	Jason	Vito	Barney

F
E
D
C
B
A

F
E
D
C
B
A

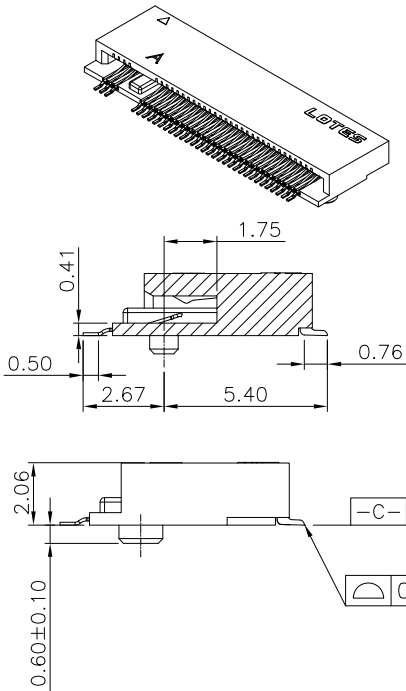
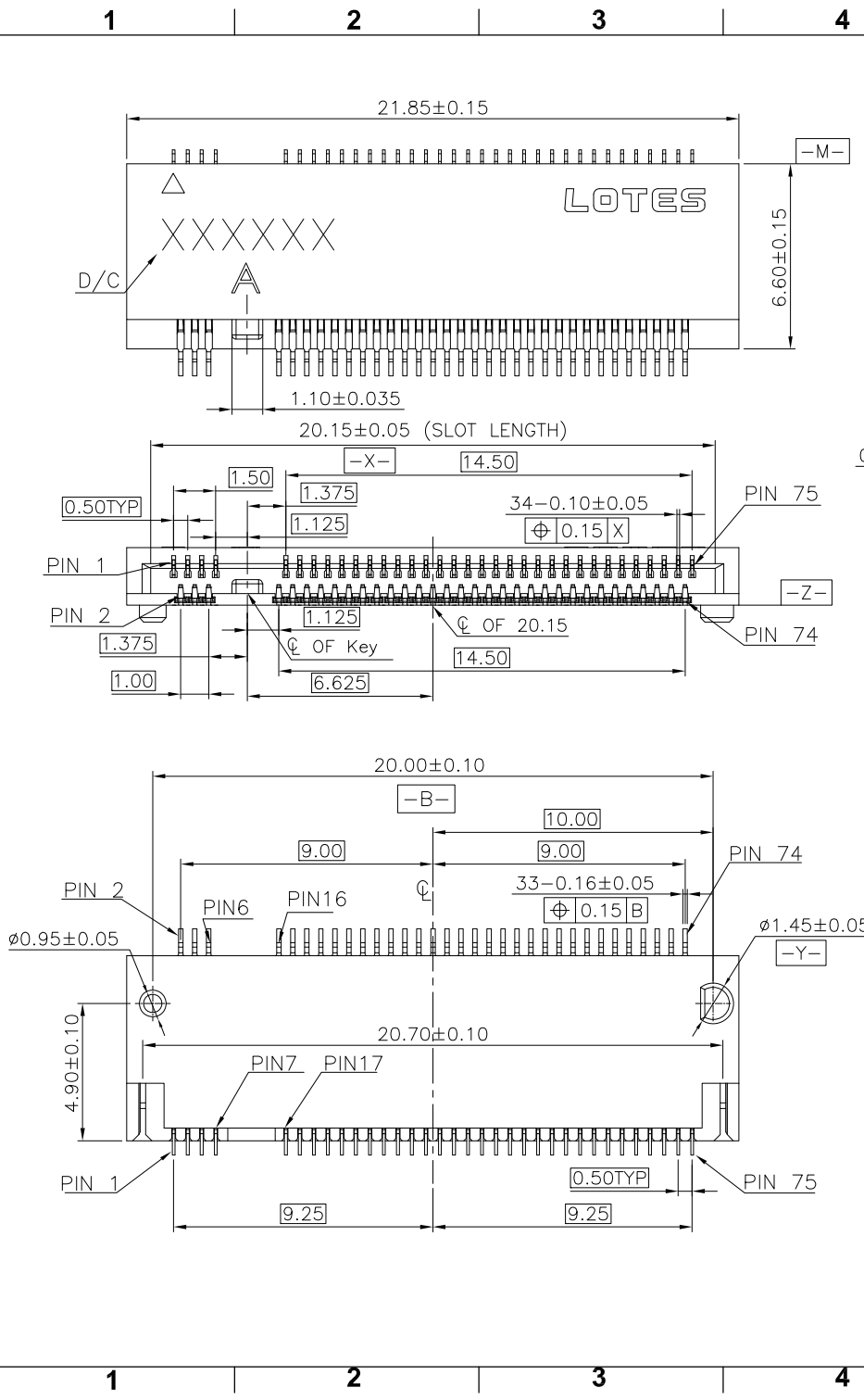

NOTES:

- MATERIAL SPECIFICATION:
 - HOUSING: LCP+40%GF, UL94V-0, COLOR: BLACK.
 - CONTACT: COPPER ALLOY.
- PLATING SPECIFICATION:
 - CONTACT: 50μ MIN. NICKEL UNDER PLATING OVER ALL. GOLD PLATING ON CONTACT SEE TABLE 1, AND SOLDER AREA IS TIN.
- HF COMPLIANT, ROHS COMPLIANT.
- DATE CODE: XXXXXX
 - DAY
 - WEEK
 - YEAR
- MECHANICAL PERFORMANCE:
 - DURABILITY: SEE TABLE
- ELECTRICAL PERFORMANCE:
 - CURRENT: 0.5A PER PIN.
 - LLCR: INITIAL $55 \text{ m}\Omega$ MAX.; FINAL $\Delta \text{LLCR} = 20 \text{ m}\Omega$ MAX..
- IR REFLOW:
 - THE TEMPERATURE SHALL BE $260 \pm 5^\circ \text{C}$ MAINTAINING 10 ± 1 SECONDS.
- PRODUCT NUMBER NOTE

A	P	C	I	X	X	X	X	X	X	X	X	X	X

 - PACKING TYPE
 - PRODUCT SERIAL NUMBER
 - K: ROHS COMPLIANT/P: HF COMPLIANT
 - TYPE SERIAL NUMBER
 - PRODUCT TYPE
 - FINISHED PRODUCT
- PLEASE DON'T INSERT CARD INTO FREE PRODUCT BEFORE SMT PROCESS.

TABLE 1

KEY NO.	A	APCI0145-P001A	1-3u" GOLD	25 CYCLES.	WITHOUT TAB
		PART NO.	CONTACT PLATING	DURABILITY	TAB

GENERAL TOLERANCES UNLESS SPECIFIED		PART NO.	LOTES			
.X \pm 0.35	X. $^\circ$ \pm 3 $^\circ$	SEE TABLE 1				
.XX \pm 0.25	X. $^\circ$ \pm 2 $^\circ$	APPROVED BY Barney	TITLE 0.5 PITCH M.2 H2.3 (A key)			
.XXX \pm 0.15	.XX $^\circ$ \pm 1 $^\circ$	CHECKED BY Vito	DWG NO. AP-APCI0145-P			
CUSTOMER DRAWING		DRAWN BY Jason		SHEET 1 / 4	SCALE 4 : 1	REV A
SIZE A4	UNITS MM [INCH]					

Assembly stack height schematic diagram

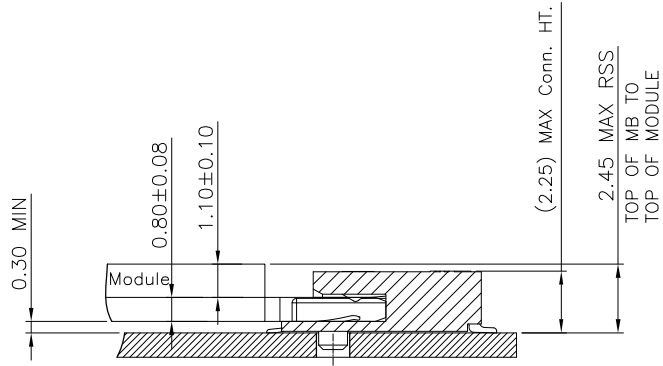

Stack-up Top Mount Single Sided Module for 1.20 max top-side component height

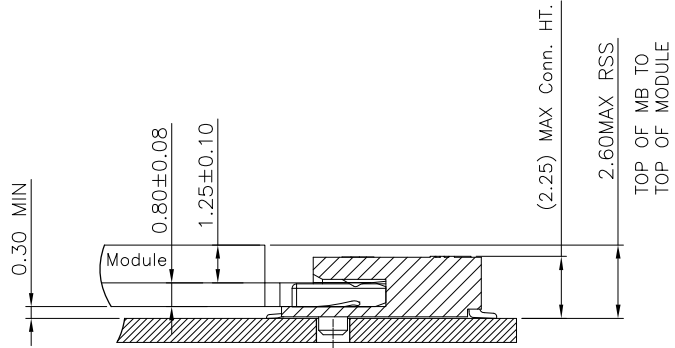

Stack-up Top Mount Single Sided Module for 1.35 max top-side component height

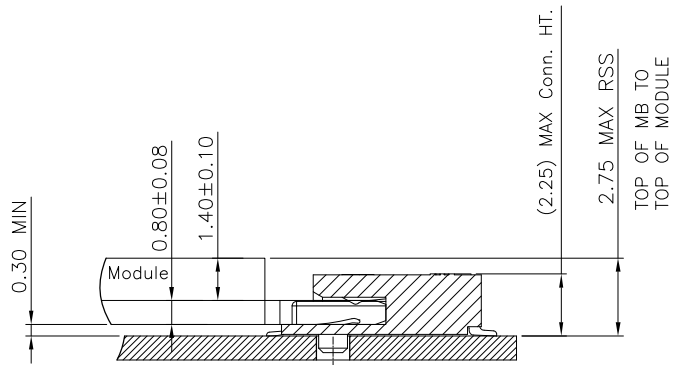

Stack-up Top Mount Single Sided Module for 1.5 max top-side component height

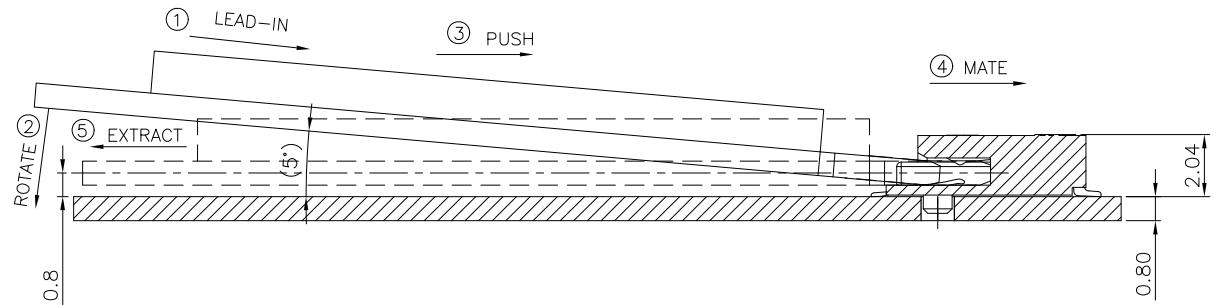

HOW TO MATE AND EXTRACT

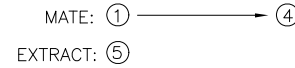

NOTE: Mating force will generate from step 3 to step 4.

GENERAL TOLERANCES UNLESS SPECIFIED		PART NO.	LOTES			
.X ± 0.35 X.° ± 3°		SEE TABLE				
.XX ± 0.25 .X.° ± 2°		APPROVED BY	TITLE			
.XXX ± 0.15 .XX.° ± 1°		Barney	0.5 PITCH M.2 H2.3 (A key)			
CUSTOMER DRAWING		CHECKED BY	DWG NO.			
		Vito	AP-APCI0145-P			
SIZE	UNITS	DRAWN BY		SHEET	SCALE	REV
A4	MM [INCH]	Jason		2 / 4	4 : 1	A

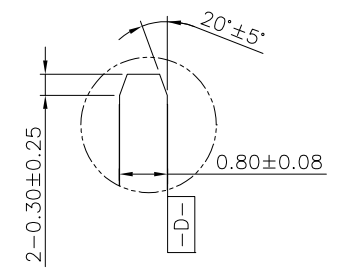
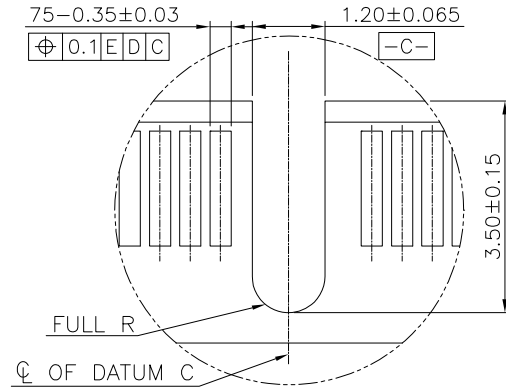
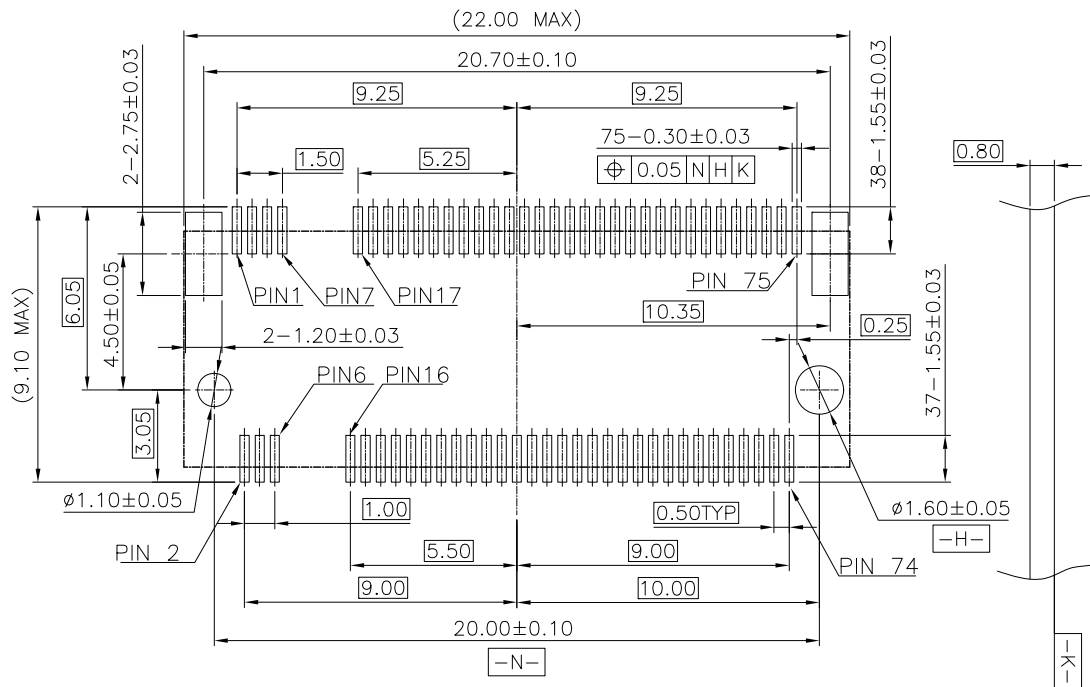
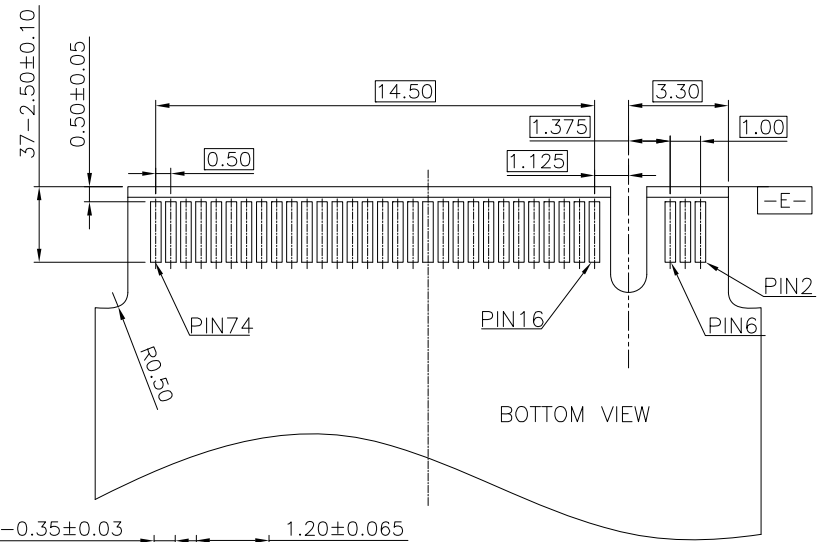
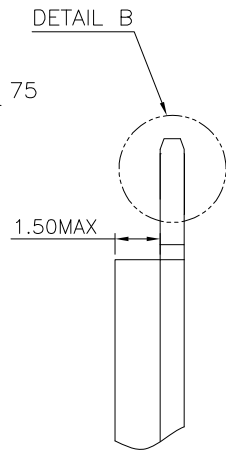
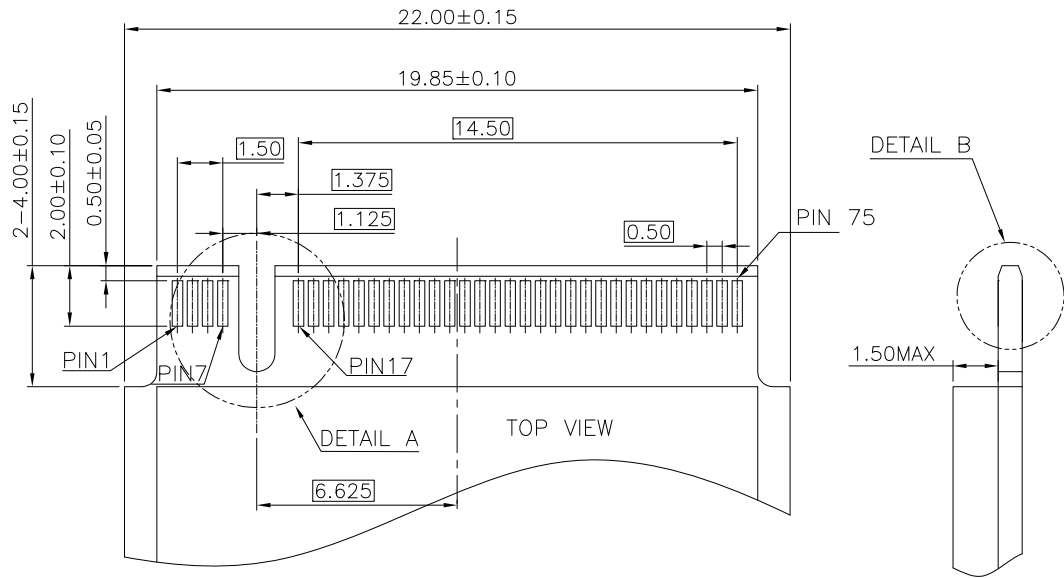

RECOMMENDED PCB LAYOUT(TOP VIEW)
 DEFAULT TOLERANCE ±0.05MM

GENERAL TOLERANCES UNLESS SPECIFIED		PART NO.		LOTES		
.X ± 0.35 X° ± 3°		SEE TABLE				
.XX ± 0.25 X° ± 2°		APPROVED BY		TITLE		
.XXX ± 0.15 .XX° ± 1°		Barney		0.5 PITCH M.2 H2.3 (A key)		
CUSTOMER DRAWING		CHECKED BY		DWG NO.		
		Vito		AP-APCI0145-P		
SIZE	UNITS	DRAWN BY		SHEET	SCALE	REV
A4	MM [INCH]	Jason				

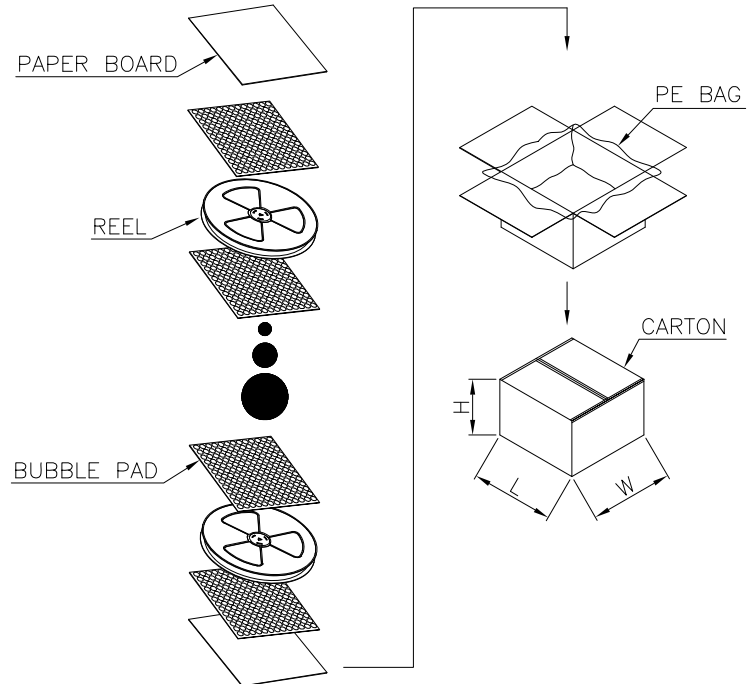
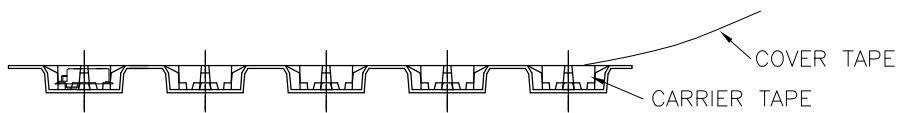
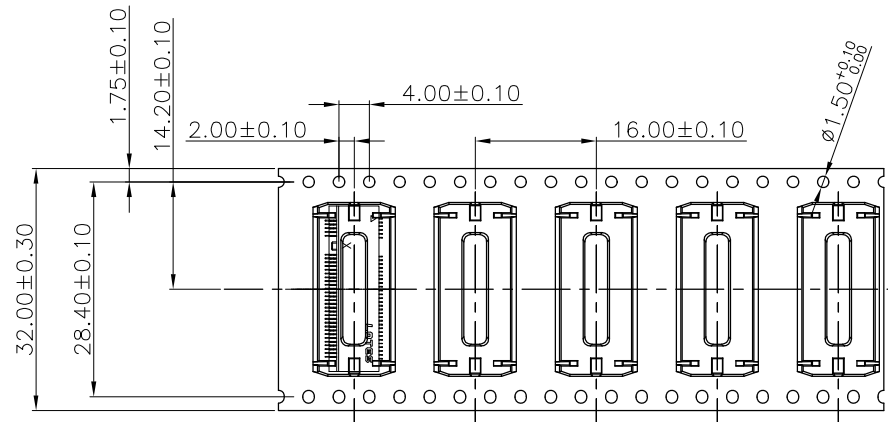
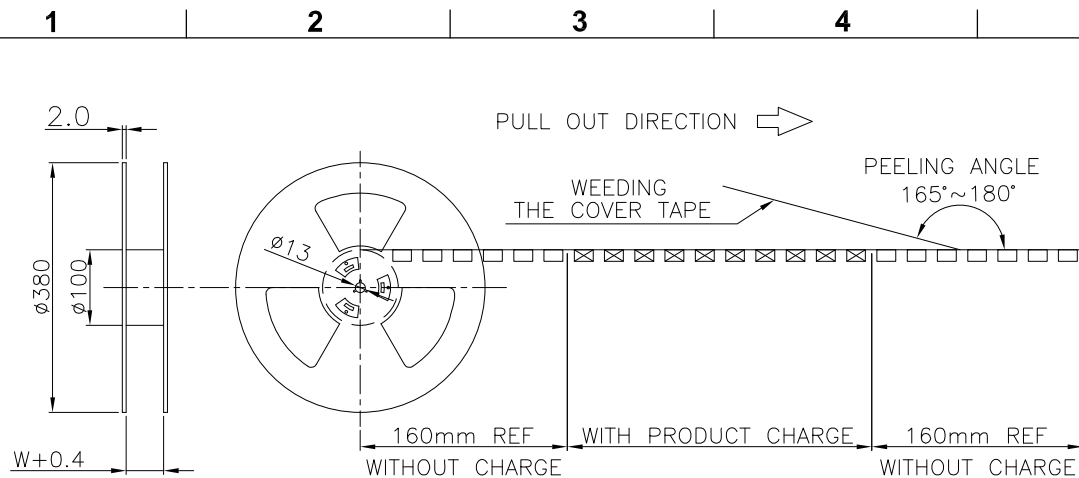

1500	12000
PCS/REEL	PCS/CARTON

GENERAL TOLERANCES UNLESS SPECIFIED		PART NO. SEE TABLE		LOTES		
.X ± 0.35	X.° ± 3°	APPROVED BY Barney				
.XX ± 0.25	.X.° ± 2°	CHECKED BY Vito		DWG NO. AP-APCI0145-P		
.XXX ± 0.15	.XX.° ± 1°	CUSTOMER DRAWING		DRAWN BY Jason		
SIZE A4	UNITS MM [INCH]	DRAWN BY Jason		SHEET 4 / 4	SCALE 1 : 1	REV A

