

REV.	ECR/N NO./DESCRIPTION	DATE	DRAWN	CHECKED	APPROVE
A	RD14008	05/21'14	Jason	Vito	Barney

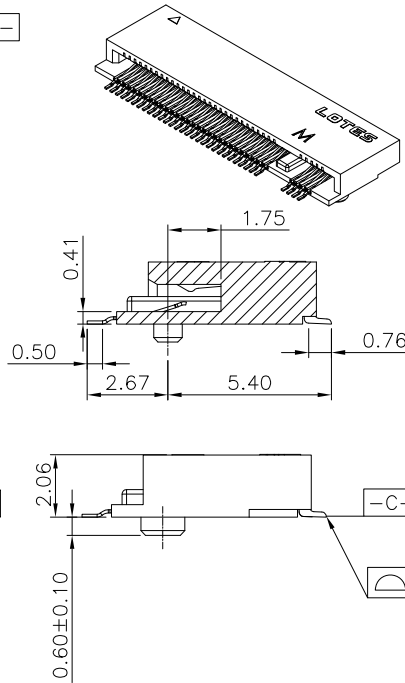
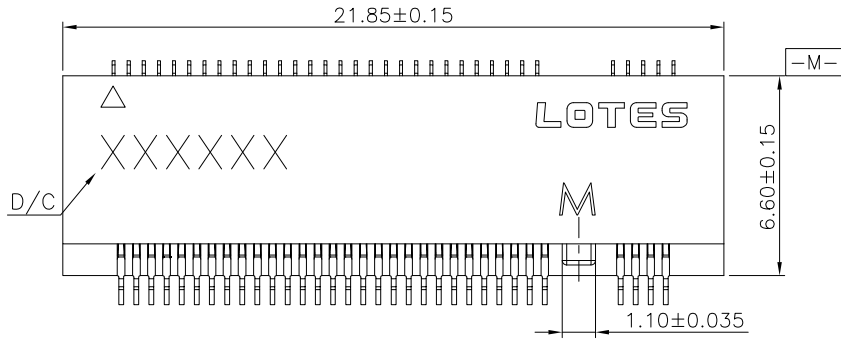

NOTES:

- MATERIAL SPECIFICATION:
 - HOUSING: LCP+40%GF, UL94V-0, COLOR: BLACK.
 - CONTACT: PHOSPHOR-COPPER.
- PLATING SPECIFICATION:
 - CONTACT: 50μ" MIN. NICKEL UNDER PLATING OVER ALL. GOLD PLATING ON CONTACT SEE TABLE 1, AND SOLDER AREA IS TIN.
- HF COMPLIANT, ROHS COMPLIANT.
- DATE CODE: XXXXXX
 - DAY
 - WEEK
 - YEAR
- MECHANICAL PERFORMANCE:
 - DURABILITY: SEE TABLE
- ELECTRICAL PERFORMANCE:
 - CURRENT: 0.5A PER PIN.
 - LLCR: INITIAL 55mΩ MAX.; FINAL ΔLLCR=20mΩ MAX..
- IR REFLOW:

THE TEMPERATURE SHALL BE 260±5°C MAINTAINING 10±1 SECONDS.
- PRODUCT NUMBER NOTE

A	P	C	I	X	X	X	X	X	X	X	X	X

 - PACKING TYPE
 - PRODUCT SERIAL NUMBER
 - K: RoHS COMPLIANT/P: HF COMPLIANT
 - TYPE SERIAL NUMBER
 - PRODUCT TYPE
 - FINISHED PRODUCT
- PLEASE DON'T INSERT CARD INTO FREE PRODUCT BEFORE SMT PROCESS.

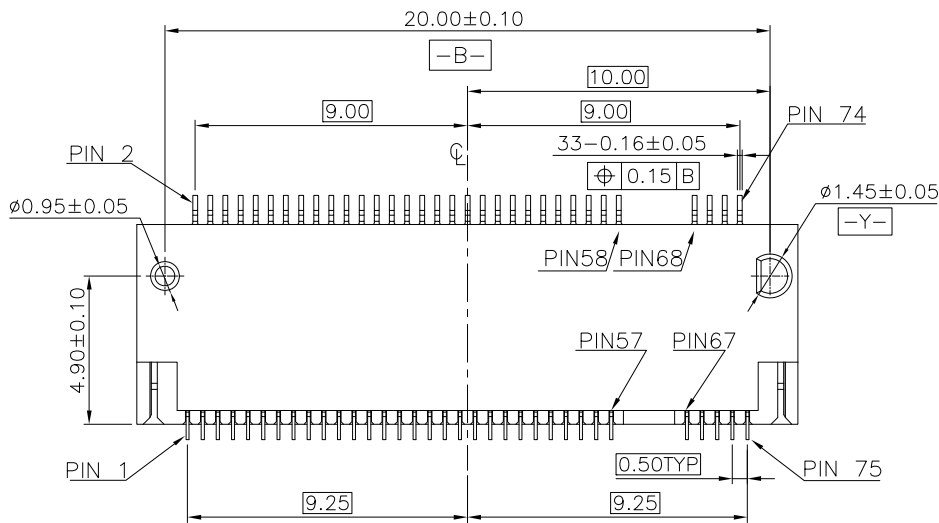
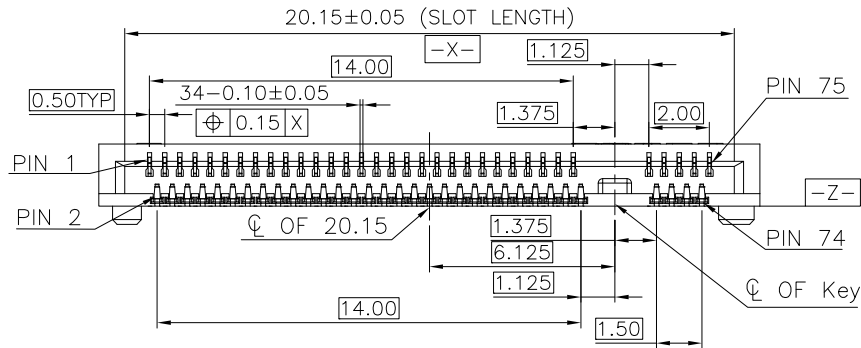
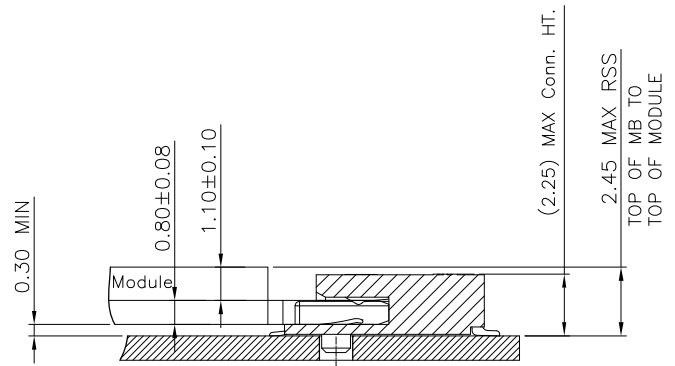

TABLE 1

KEY NO.	PART NO.	CONTACT PLATING	DURABILITY	TAB
M	APCI0146-P002A	10μ" GOLD	25 CYCLES.	WITHOUT
M	APCI0146-P001A	1-3μ" GOLD	25 CYCLES.	WITHOUT

GENERAL TOLERANCES UNLESS SPECIFIED		PART NO.	LOTES		
.X ± 0.35	X.° ± 3°	SEE TABLE 1			
.XX ± 0.25	.X.° ± 2°	APPROVED BY	TITLE		
.XXX ± 0.15	.XX.° ± 1°	Barney	0.5 PITCH M.2 H2.3 (M key)		
CUSTOMER DRAWING		CHECKED BY	DWG NO.		
		Vito	AP-APCI0146-P		
SIZE	UNITS	DRAWN BY	SHEET	SCALE	REV
A4	MM [INCH]	Jason			

Assembly stack height schematic diagram



Stack-up Top Mount Single Sided Module for 1.20 max top-side component height

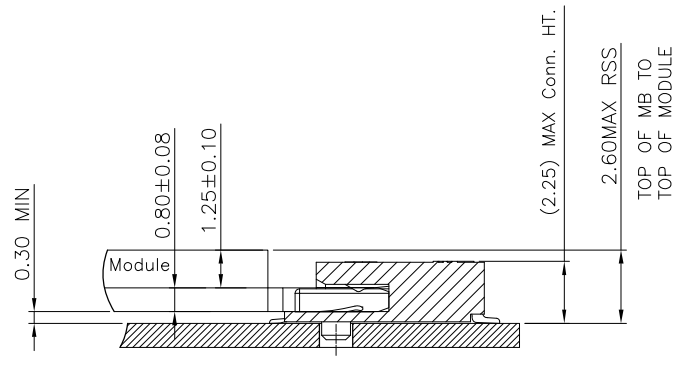

Stack-up Top Mount Single Sided Module for 1.35 max top-side component height

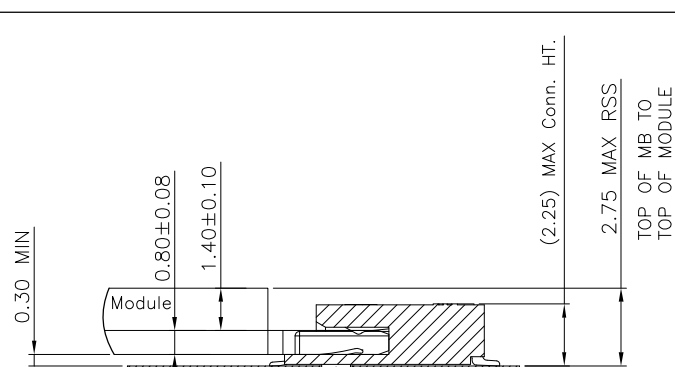

Stack-up Top Mount Single Sided Module for 1.5 max top-side component height

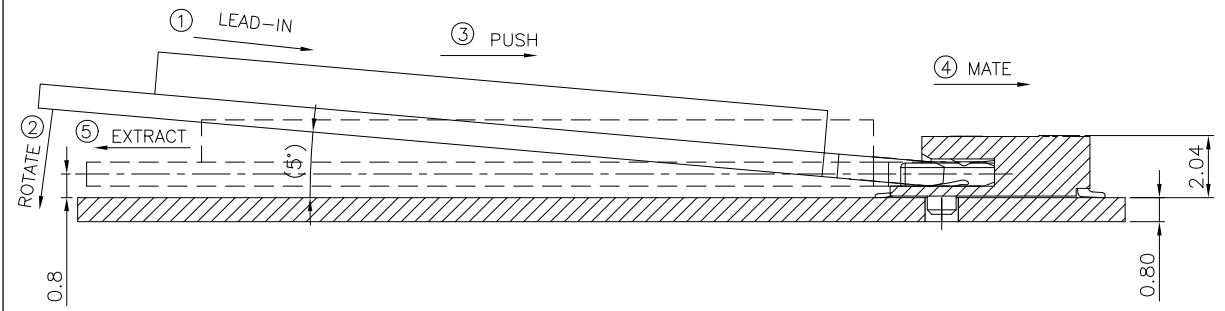

HOW TO MATE AND EXTRACT

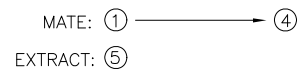

NOTE: Mating force will generate from step 3 to step 4.

GENERAL TOLERANCES UNLESS SPECIFIED		PART NO.	LOTES			
SEE TABLE		SEE TABLE				
.X ± 0.35	X.° ± 3°	APPROVED BY	TITLE			
.XX ± 0.25	.X.° ± 2°	Barney	0.5 PITCH M.2 H2.3 (M key)			
.XXX ± 0.15	.XX.° ± 1°	CHECKED BY	DWG NO.			
CUSTOMER DRAWING		Vito	AP-APCI0146-P			
SIZE	UNITS	DRAWN BY		SHEET	SCALE	REV
A4	MM [INCH]	Jason		2 / 4	4 : 1	A

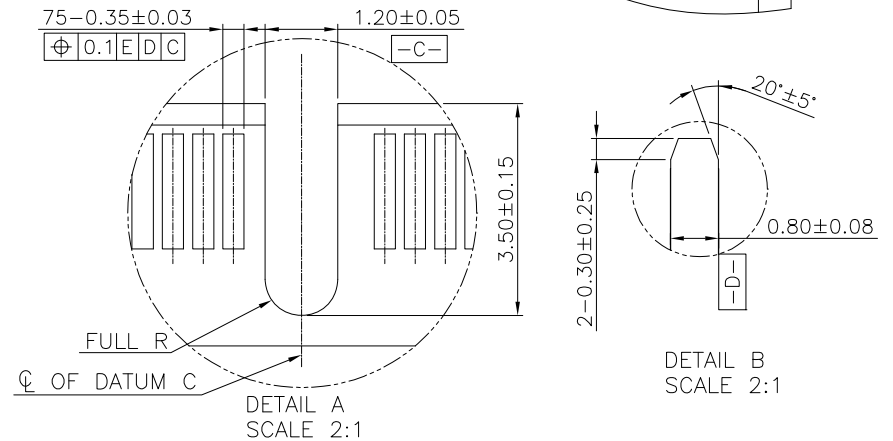
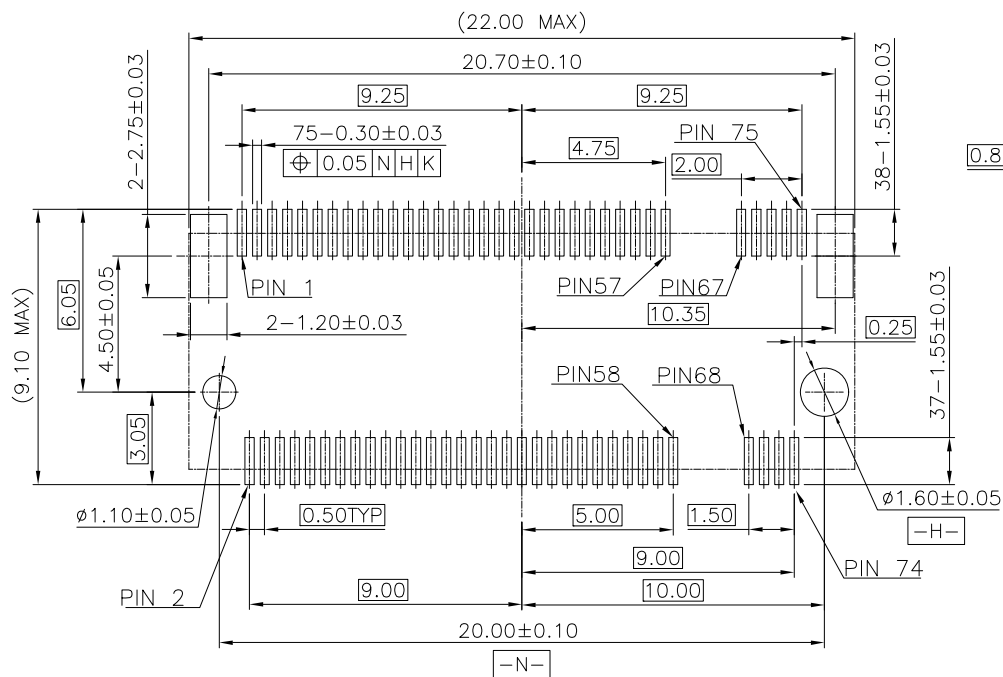
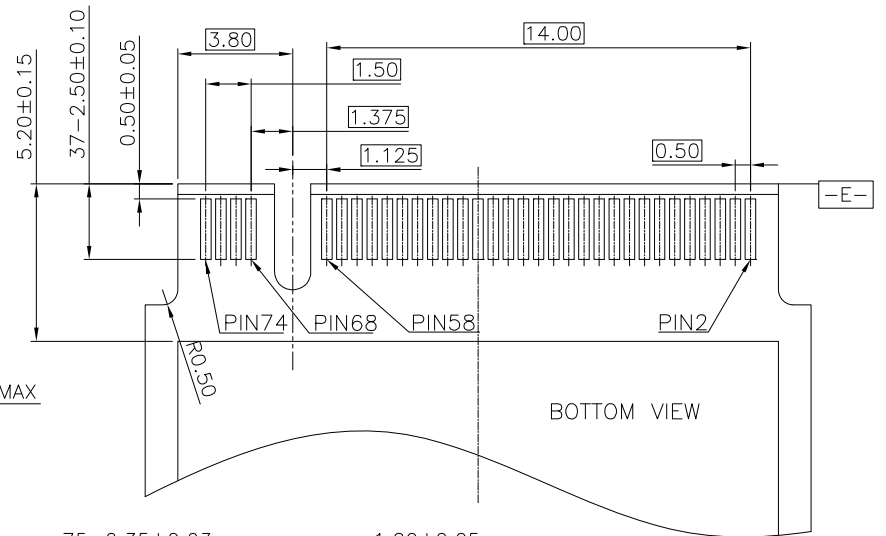
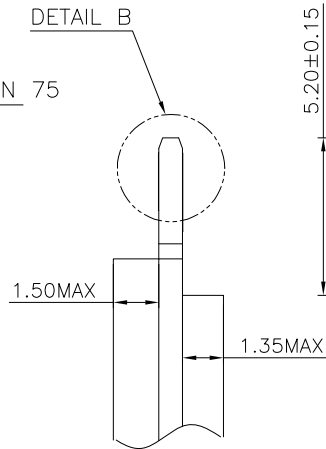
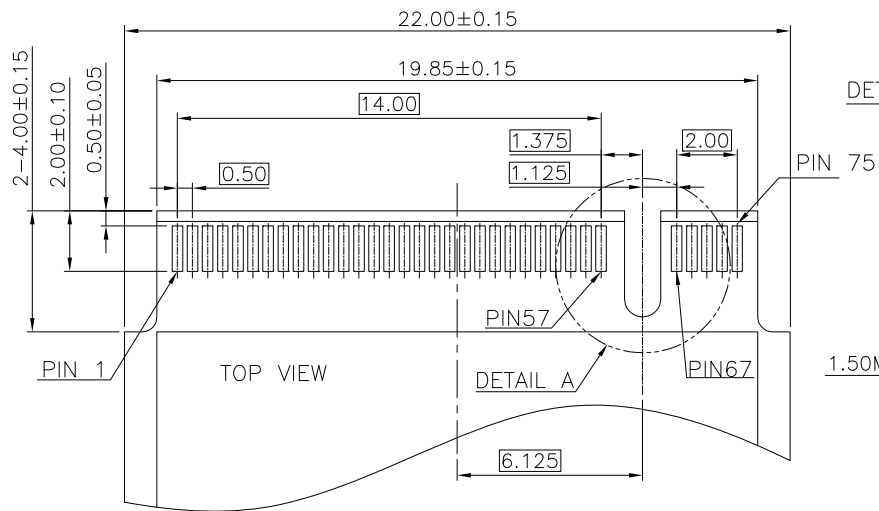

GENERAL TOLERANCES UNLESS SPECIFIED		PART NO.	LOTES		
.X ± 0.35 X.° ± 3°		SEE TABLE			
.XX ± 0.25 X.° ± 2°		APPROVED BY	TITLE		
.XXX ± 0.15 .XX° ± 1°		Barney	0.5 PITCH M.2 H2.3 (M key)		
CUSTOMER DRAWING		CHECKED BY	DWG NO.		
		Vito	AP-APCI0146-P		
SIZE	UNITS	DRAWN BY	SHEET	SCALE	REV
A4	MM [INCH]	Jason			

RECOMMENDED PCB LAYOUT(TOP VIEW)
DEFAULT TOLERANCE ±0.05MM

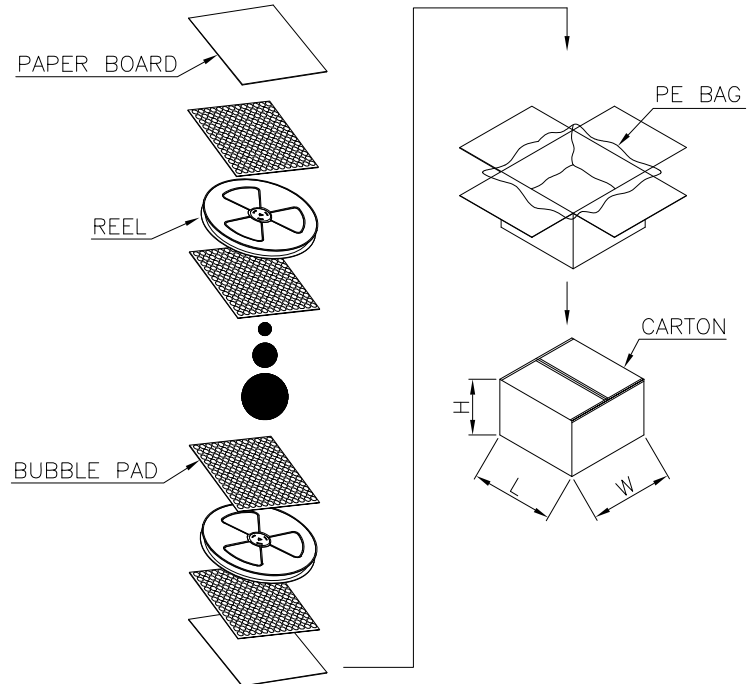
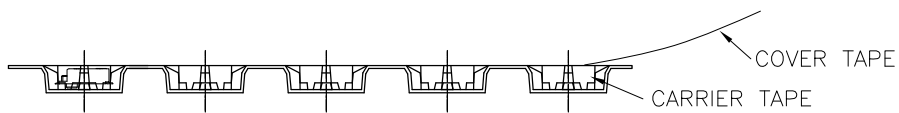
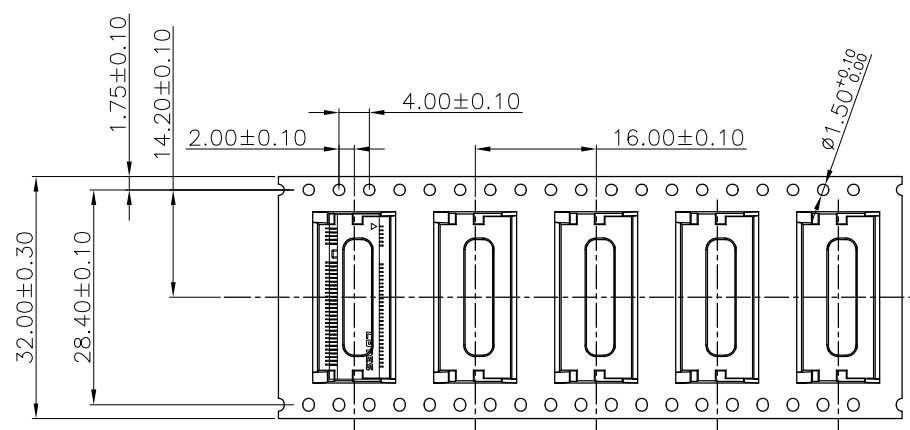
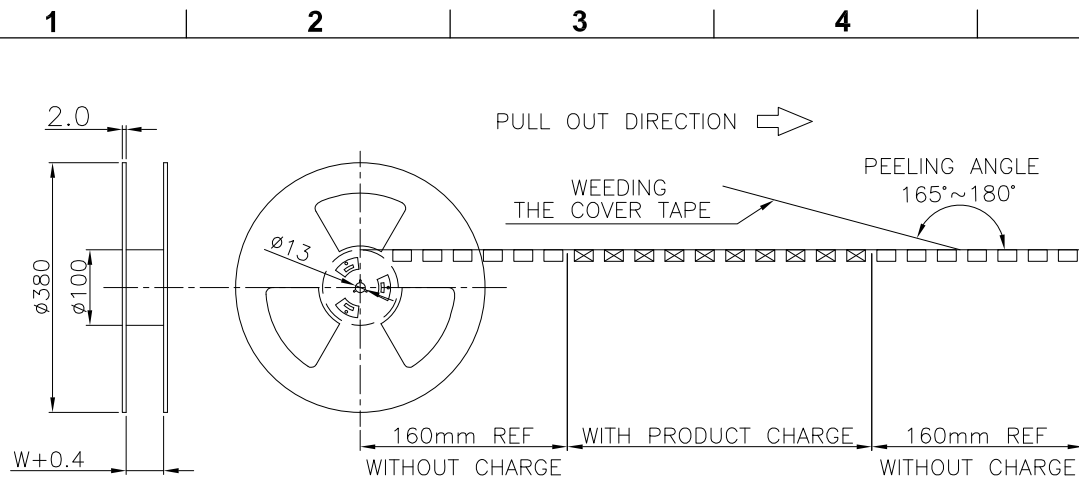

1500	12000
PCS/REEL	PCS/CARTON

GENERAL TOLERANCES UNLESS SPECIFIED		PART NO. SEE TABLE		LOTES					
.X ± 0.35	X.° ± 3°	APPROVED BY Barney					TITLE 0.5 PITCH M.2 H2.3(M-KEY)		
.XX ± 0.25	.X.° ± 2°	CHECKED BY Vito		DWG NO. AP-APCI0146-P					
.XXX ± 0.15	.XX.° ± 1°	CUSTOMER DRAWING							
SIZE	UNITS	DRAWN BY Jason					SHEET	SCALE	REV
A4	MM [INCH]						4 / 4	1 : 1	A