

NOTE: UNLESS OTHERWISE SPECIFIED.
 1. DIMENSIONS SHALL BE INTERPRETED PER ASME Y14.5M-1994.
 2. SPEC. ARE SHOWN ON DRAWING "307-0300-202".
 3. MATERIALS ARE SHOWN ON DRAWING "307-0000-876".
 ▲ PRODUCT NO. MATRIX:

HL54 * * * - * * * *

NO. OF SINGLE ROW POS.
 02 = 02/04 POS.
 03 = 03/06 POS.
 ...

CONTACT AREA PLATING
 F = GOLD FLASH WITH RoHS COMPLIANCE
 V = 15u" MIN. GOLD WITH RoHS COMPLIANCE
 H = 30u" MIN. GOLD WITH RoHS COMPLIANCE
 Z = 3~5u" GOLD WITH RoHS COMPLIANCE

5. PLEASE CONTACT FOXCONN SALES REPRESENTATIVE TO VERIFY PRODUCT DETAILS&AVAILABILITY.
 6. HARMFUL MATERIAL CONTROL PLEASE FOLLOW FOXCONN'S DOC. "EPI12".

REV.	ECN. No.	APPD.
A	HC990483	DICK LEE 2/6'99
B	HC990506	DICK LEE 2/10'99
C	HC991176	DICK LEE 4/10'99
D	HC991670	DICK LEE 5/26'99
E	ICD-017847	Yihsin Chen 11/1'01
F	HC049892	Ady Zhou 10/30'04
G	BC06747198	Yusan 8/17'06
H	BC07701957	Yusan
J	BC087046736	Jake W.Y
K	BC087161402	Jake W.Y

MODIFY CODE
 SEE DRAWING "307-0000-297"
 TAIL LENGTH OPTION
 NONE: DIM E=2.50mm
 L2: DIM E=3.50mm
 MATING OPTION FOR POS. 2/4~6/12
 NONE: CENTER LOCKING WINDOW (TYPE I)
 C: CENTER POLARIZATION SLOT (TYPE II)
 NONE: NO KINKED
 K: THE 3RD & N-2 PINS OF TERMINALS ARE DEFORMED WITH KINKS

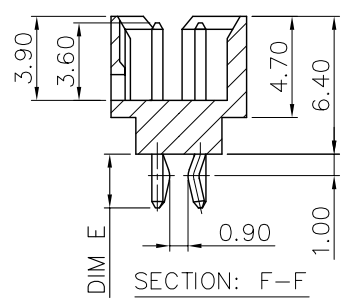
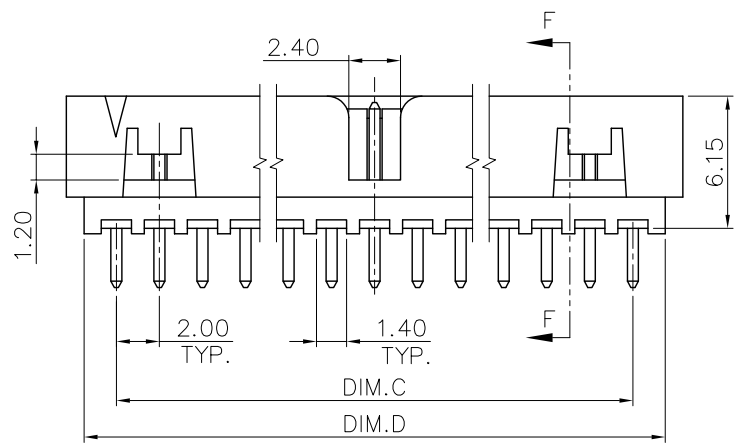

7/14~25/50 POS. TYPE

X.±	X'±	UNITS	mm	NAME(INTENDED USE)	FOXCONN HON HAI PRECISION IND. CO.,LTD. TAIPEI, TAIWAN, R.O.C.	
.X± 0.38	.X'±	MAT'L		SHROUDED HEADER		
.XX± 0.25	.XX'±			PART NO.(INTENDED USE)	TITLE: CUSTOMER DRAWING	
.XXX±	.XXX'±	FINISH		HL54 SERIES	VERTICAL, 2.0mm PITCH, T/H	
THESE DRAWINGS AND SPECIFICATIONS ARE THE PROPERTY OF HON HAI PRECISION IND. CO., LTD. AND SHALL NOT BE REPRODUCED, COPIED OR USED IN ANY MANNER WITHOUT THE PRIOR WRITTEN CONSENT OF HON HAI PRECISION IND. CO., LTD.				APPD: Jake W.Y	DWG NO:	
				CHKD: D.J.Chen	307-0000-386	
				DR: JustinFeng 12/23'08		
				SCALE	SHEET	REV.
				N/A	1/2	K

REV.	ECN. NO.	APPD.

CENTER LOCKING WINDOW

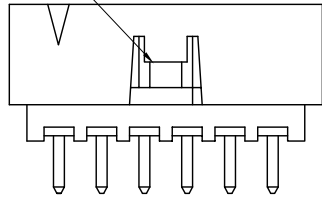

TYPE I FOR 2/4~6/12POS.

CENTER POLARIZATION SLOT

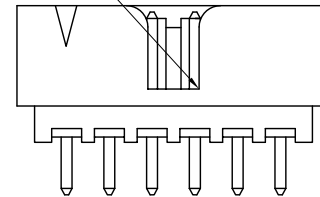

TYPE II FOR 2/4~6/12POS.

HOUSING EXTERNAL FORM

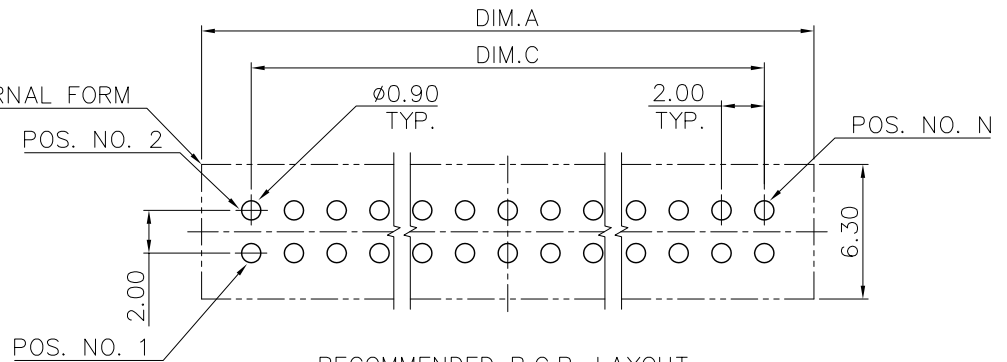

RECOMMENDED P.C.B. LAYOUT

TOLERANCE IS ±0.05

⚠

HL5425*_*****	25/50	52.65	50.85	48.00	51.00
HL5422*_*****	22/44	46.65	44.85	42.00	45.00
HL5420*_*****	20/40	42.65	40.85	38.00	41.00
HL5417*_*****	17/34	36.65	34.85	32.00	35.00
HL5415*_*****	15/30	32.65	30.85	28.00	31.00
HL5414*_*****	14/28	30.65	28.85	26.00	29.00
HL5413*_*****	13/26	28.65	26.85	24.00	27.00
HL5412*_*****	12/24	26.65	24.85	22.00	25.00
HL5411*_*****	11/22	24.65	22.85	20.00	23.00
HL5410*_*****	10/20	22.65	20.85	18.00	21.00
HL5409*_*****	09/18	20.65	18.85	16.00	19.00
HL5408*_*****	08/16	18.65	16.85	14.00	17.00
HL5407*_*****	07/14	16.65	14.85	12.00	15.00
HL5406*_*****	06/12	14.65	12.85	10.00	13.00
HL5405*_*****	05/10	12.65	10.85	8.00	11.00
HL5404*_*****	04/08	10.65	8.85	6.00	9.00
HL5403*_*****	03/06	8.65	6.85	4.00	7.00
HL5402*_*****	02/04	6.65	4.85	2.00	5.00
PART NO.	NO. OF POS.	DIM.A	DIM.B	DIM.C	DIM.D

X.±	X'.±	UNITS mm	NAME(INTENDED USE)	FOXCONN HON HAI PRECISION IND. CO.,LTD. TAIPEI, TAIWAN, R.O.C.
.X± 0.38	.X'±		SHROUDED HEADER	
.XX± 0.25	.XX'±	FINISH	PART NO.(INTENDED USE)	TITLE: CUSTOMER DRAWING
.XXX±	.XXX'±		HL54 SERIES	VERTICAL,2.0mm PITCH,T/H
THESE DRAWINGS AND SPECIFICATIONS ARE THE PROPERTY OF HON HAI PRECISION IND. CO., LTD. AND SHALL NOT BE REPRODUCED, COPIED OR USED IN ANY MANNER WITHOUT THE PRIOR WRITTEN CONSENT OF HON HAI PRECISION IND. CO., LTD.			APPD: Jake W.Y	DWG NO: 307-0000-386
Q'TY			CHKD: D.J.Chen	SCALE SHEET REV.
			DR:JustinFeng 12/23'08	N/A 2/2 K

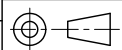

ITEM	DESCRIPTION	Q'TY	MATERIAL	TREATMENT	REMARK
1	HOUSING	1	HIGH TEMPERATURE THERMOPLASTIC, UL 94V-0	HOUSING COLOR BLACK	
2	CONTACT	SEE NOTES BELOW	COPPER ALLOY	A) NICKEL UNDER PLATING OVER ALL, THICKNESS : 50u" MIN.. B) GOLD PLATING AT CONTACT AREA WITH RoHS COMPLIANCE C) TIN PLATING AT SOLDER AREA WITH RoHS COMPLIANCE	

NOTES:

1. PRODUCT No. MATRIX:

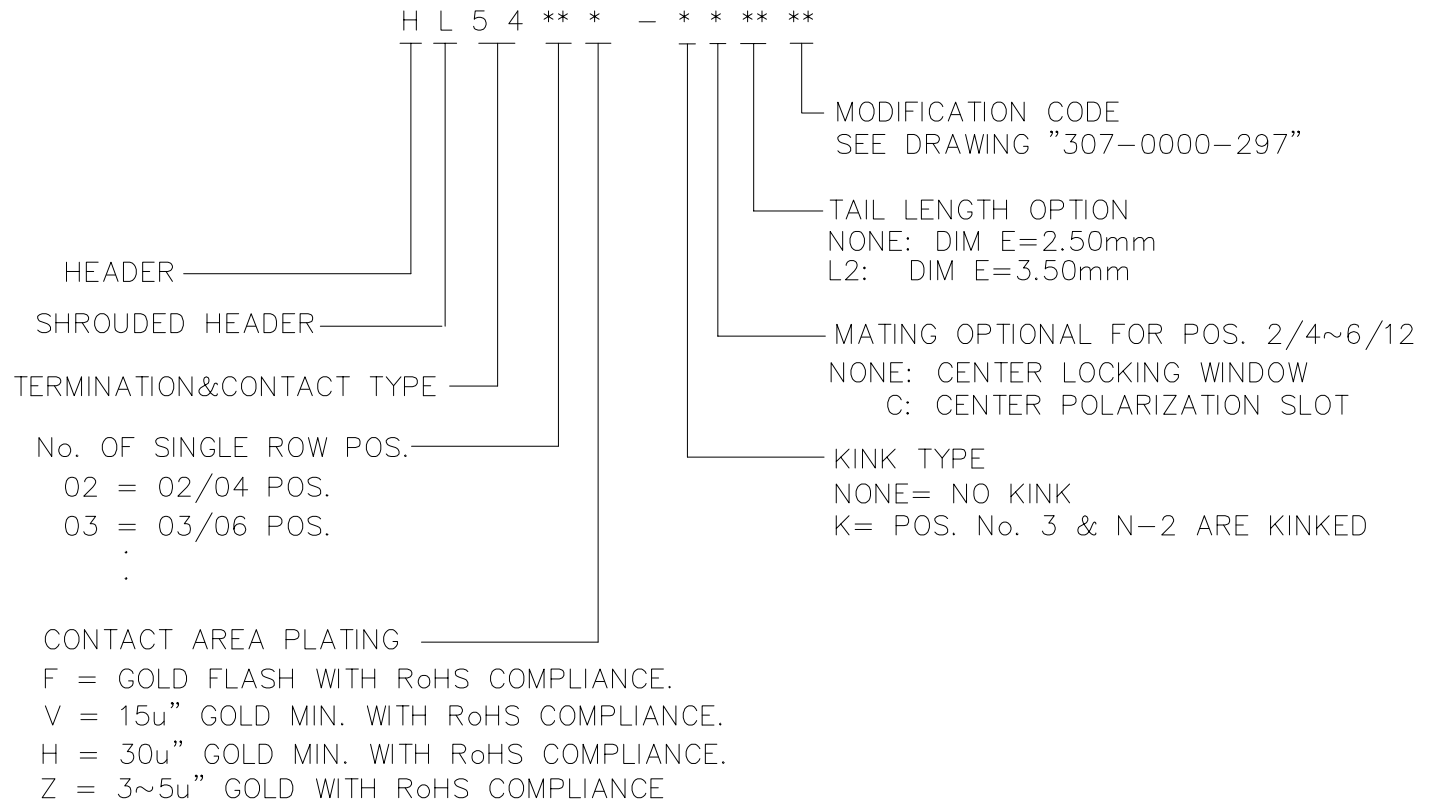

2.HARMFUL MATERIAL CONTROL PLEASE FOLLOW FOXCONN'S DOC. "EPI12".

3.PLEASE CONTACT FOXCONN SALES REPRESENTATIVE TO VERIFY PRODUCT DETAIL & AVAILABILITY.

F	BC087161573	Jake W.Y
E	BC087046889	Jake W.Y
D	BC07701893	Yusan
C	BC06747615	Yusan
B	HC991177	Dick Lee 4/9'99
A	HC990483	Dick Lee 2/6'99
REV.	ECN No.	APPD.

FOXCONN		HON HAI PRECISION IND. CO.,LTD. TAIPEI, TAIWAN, R.O.C.	
APPD. :	Jake W.Y	TITLE :	MATERIAL SHEET T/H,2.0mm PITCH,0.51mm SQ.
CHKD. :	D.J.Chen	PROD. SERIES :	HL54 SERIES
DR. :	JustinFeng12/23'08	DWG. No :	307-0000-876
		REV. :	F SHEET : 1/1

PRODUCT SPECIFICATIONS:

1. MATERIAL AND FINISH:

1-1. HOUSING :

THERMOPLASTIC , UL94 V-0 RATING.

1-2. CONTACT:

COPPER ALLOY, 50u" MIN. NICKEL UNDER PLATING, TIN OR GOLD PLATING OVER NICKEL.

2. ELECTRICAL CHARACTERISTICS:

2-1. CONTACT CURRENT RATING : 2 AMPERES PER CONTACT.

2-2. LOW LEVEL CONTACT RESISTANCE : 30 MILLIOHMS MAX. INITIALLY;
40 MILLIOHMS MAX. AFTER LIFE TESTING.

2-3. INSULATION RESISTANCE: 1000 MEGOHMS MIN. .

2-4. DIELECTRIC WITHSTANDING VOLTAGE: 500VAC AT SEA LEVEL.

2-5. CAPACITANCE: 2 PICO FARADS MAX. AT 1 MHZ BETWEEN RANDOMLY ADJACENT CONTACTS.

3. MECHANICAL CHARACTERISTICS:

3-1. CONTACT RETENTION FORCE: 1.36 Kg MIN. PER CONTACT.

3-2. INSERTING FORCE : 0.4Kg MAX. PER CONTACT;
WITHDRAW FORCE : 0.02Kg MIN. PER CONTACT;

4. ENVIRONMENTAL DATA:

4-1. SOLDERABILITY: PASSED EIA-364-52.

4-2. OPERATION TEMPERATURE: -55°C TO +105°C.

4-3. HARMFUL MATERIAL CONTROL PLEASE FOLLOW FOXCONN'S DOC. "EPI12".

5. PLEASE CONTACT FOXCONN SALES REPRESENTATIVE TO VERIFY PRODUCT DETAILS&AVAILABILITY.

FOXCONN HON HAI PRECISION IND. CO.,LTD.
TAIPEI, TAIWAN, R.O.C.

APPD. : Wolfe Liu	TITLE : SPECIFICATION 4 WALLS, 2.0mm PITCH	
CHKD. :	PROD. SERIES : HL54 SERIES	
DR. : JustinFeng5/6'09	DWG. NO : 307-0300-202	
	REV. : BX1	SHEET : 1/1

B	BC06754320	Yusan 9/7'06
A	HC992767	VINCENT LAI
REV.	ECN NO.	APPD.

H L ** ** * - (*) (**) **

(1) (2)

CODE	REMOVED PINS
NONE	STANDART PRODUCT,FULL PIN
D0	POS. NO. 1
D1	LAST PIN
D2	POS. NO. 20
D3	POS. NO. 21
D4	POS. NO. 8
D6	POS. NO. 25
D7	POS. NO. 26
D8	POS. NO. 28
D9	POS. NO. 15
E1	POS. NO. 24
E2	POS. NO. 22
E3	POS. NO. 30
E4	POS. NO. 38
E5	POS. NO. 9 & 10
E6	POS. NO. 4 , 6 & 9
E7	POS. NO. 17 & 18
P0	POS. NO. 4
P1	POS. NO. 6
P3	POS. NO. 7
P4	POS. NO. 5
P5	POS. NO. 10
P6	POS. NO. 2
P7	POS. NO. 3
P8	POS. NO. 17
P9	POS. NO. 9
L0	POS. NO. 27
L1	POS. NO. 12
L3	POS. NO. 32
L5	POS. NO. 18
L6	POS. NO. 14
L7	POS. NO. 16
L8	POS. NO. 1,2,3,4,14,15&16
L9	POS. NO. 25
T0	POS. NO. 1,2,10,11&12
T1	POS. NO. 7 & 8
T2	POS. NO. 3, 25 & 26
T3	POS. NO. 8 & N
T4	POS. NO. 3, 19, 20 & 29
T5	POS. NO. 8 & 9
T6	POS. NO. 3 & LAST PIN
T7	POS. NO. 8 & 19
T8	POS. NO. 30 & 32
T9	POS. NO. 25, 27 & 28
U0	POS. NO. 3, 5, 7 & 9
U1	POS. NO. 3 & 5
U2	POS. NO. 11
U3	POS. NO. 19
U4	POS. NO. 13
U5	POS. NO. 13,15 & 16
U6	POS. NO. 4 & 7
U7	POS. NO. 8 & 13
U8	POS. NO. 4, 5 & 6
U9	POS. NO. 1 & 11

REV.	ECN. NO.	APPD.
A	HC97734	I. K. LIU 2/25'97
B	HC97491	I. K. LIU 3/31'97
C	HC971719	I. K. LIU 8/14'97
D	HC98569	I. K. LIU 3/7'98
E	HC98886	DICK Lee 4/10'98
F	HC981840	DICK Lee 7/14'98
G	HC983061	DICK Lee 11/30'98
H	HC990456	DICK Lee 2/8'99
J	MC993573	Lai 11/6'99
K	MC003570	Charles 10/20'00
L	MC011102	Charles 4/01'01
M	MC011803	YIHSIN 8/01'01
N	IC022083	Yihsin Chen 6/5,02
P	IC0214775	Ivan Laiw 3/11,03
Q	BC0361580	Michael Lai 5/17,03
R	BC0383959	Yihsin Chen 11/14,03
S	BC0385543	Yihsin Chen JAN/10,04
T	HC040839	Ady Zhou 2/06'04
U	HC0511298	Ady Zhou 11/12'05
V	BC06769729	Yusan
W	BC077008200	Yusan
Y	BC077030285	Yusan
Z	BC087045415	Jake W.Y

REMARK:

- (1) NONE: STANDARD PRODUCT
 (X): TO BE SPECIFIED ON CORRELATIVE CUSTOMER DRAWING
- (2) NONE: STANDARD PRODUCT (COLOR BLACK)
 K: THE FIRST & LAST PAIRS OF TERMINALS ARE DEFORMED WITH KINKS
 W: HOUSING COLOR IVORY, PANTONE WARM GRAY 1C
 U: HOUSING COLOR BLUE, PANTONE 661C
 R: HOUSING COLOR RED, PANTONE 199C
 Y: HOUSING COLOR YELLOW, PANTONE 123C
 G: HOUSING COLOR GREEN, PANTONE 375C
 N: HOUSING COLOR GREEN, PANTONE 7487C
 S: HOUSING COLOR BLUE, PANTONE 285C
 Z: HOUSING COLOR RED, PANTONE 1788C
 M: HOUSING COLOR PURPLE, PANTONE 512C
 H: HOUSING COLOR ORANGE, PANTONE 021C
- KW: THE FIRST & LAST PAIRS OF TERMINALS ARE DEFORMED WITH KINKS, HOUSING COLOR IVORY
 K3: THE FIRST & LAST PAIRS OF TERMINALS ARE DEFORMED WITH KINKS (SPECIAL MODIFICATION CODE)
- (3) FOR REMOVED PIN(S) LOCATED AT FIRST OR LAST PAIR, KINKED POSITION(S) SHOULD BE CHANGED TO THE NEAREST PAIR.
- (4) PLEASE CONTACT FOXCONN SALES REPRESENTATIVE TO VERIFY PRODUCT DETAILS & AVAILABILITY.
- (5) HARMFUL MATERIAL CONTROL PLEASE FOLLOW FOXCONN'S DOC. "EPI12".

FOXCONN HON HAI PRECISION IND. CO.,LTD. TAIPEI, TAIWAN, R.O.C.	
APPD. : Jake W.Y	TITLE : CUSTOMER DRAWING
CHKD. : D.J.Chen	PROD. SERIES : HL SERIES
DR. : JustinFeng 10/7'08	DWG. NO : 307-0000-297
	REV. : ZX1 SHEET : 1/1