

RoHS

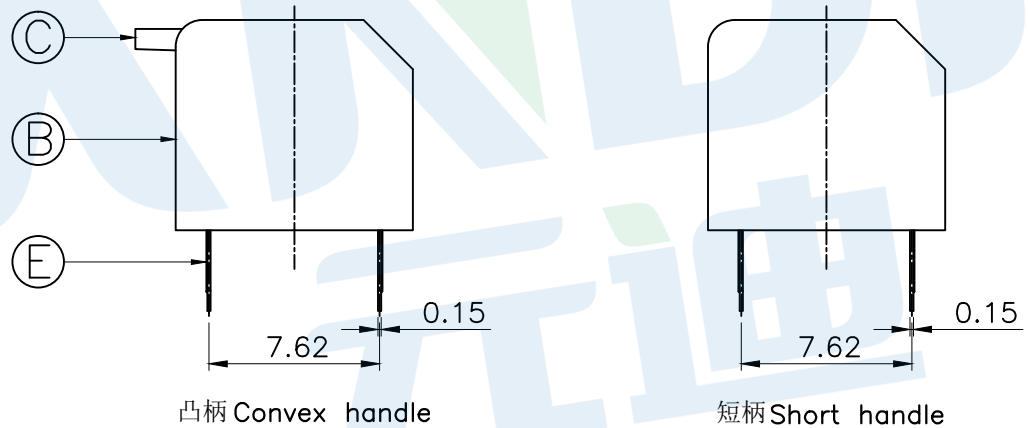
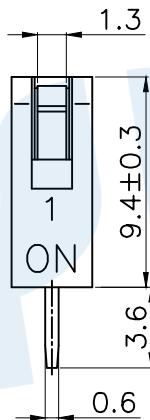
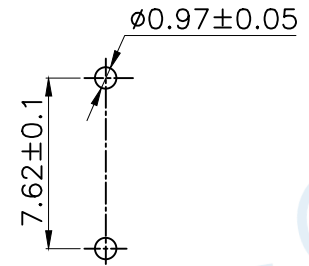
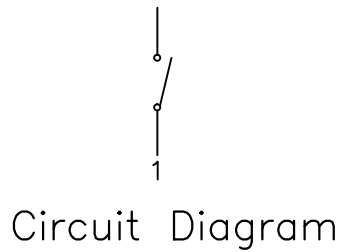
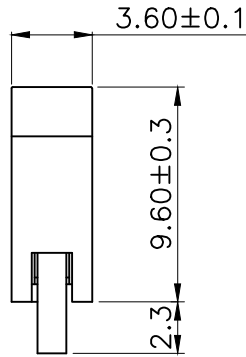

- NOTE:
- 1.Rating: 24V 25mA DC
 - 2.Insulation Resistance: $\geq 100 \text{ M}\Omega$
 - 3.Withstand voltage: AC 500V 1Minute
 - 4.Operating Force Range: 400gf Max
 - 5.Mechanical Life: 3,000 Cycles

| Number of digits(位数) | 1P | 2P | 3P | 4P | 5P | 6P | 7P | 8P | 9P | 10P | 12P |
|---------------------------|--------|--------|--------|--------|--------|--------|--------|--------|--------|--------|--------|
| Cover/red 凸柄 盖子/红色 | TE-01 | TE-02 | TE-03 | TE-04 | TE-05 | TE-06 | TE-07 | TE-08 | TE-09 | TE-10 | TE-12 |
| 短柄 | TE-01D | TE-02D | TE-03D | TE-04D | TE-05D | TE-06D | TE-07D | TE-08D | TE-09D | TE-10D | TE-12D |
| Cover/blue 凸柄 盖子/蓝色 | TE-01R | TE-02R | TE-03R | TE-04R | TE-05R | TE-06R | TE-07R | TE-08R | TE-09R | TE-10R | TE-12R |
| 短柄 | TE-01L | TE-02L | TE-03L | TE-04L | TE-05L | TE-06L | TE-07L | TE-08L | TE-09L | TE-10L | TE-12L |

| | | | | | |
|-----|--------------|--------|-----|-------------------|--------------|
| Ⓔ | Terminal | | 2 | Phosphorus bronze | Gold plating |
| Ⓗ | Potting glue | | | Epoxy resin | Black |
| Ⓒ | Handle | | 1 | PBT | White |
| Ⓑ | Cover | | 1 | PBT | Red/Blue |
| Ⓐ | Base | | 1 | PBT | Black |
| NO. | Name | Number | Qty | Materil | Remarks |

YUANDI® Yuandi Electronics Co, Ltd
元迪

| | | | |
|----------|------|-------|------------|
| design | date | name | DIP SWITCH |
| Review | date | model | TE-01 |
| Approved | date | | |

Drawing number: angle $\pm 2'$
 10~30 ± 0.30
 5~10 ± 0.20
 ~ 5 ± 0.10
 Tolerance not specified Proportion 1:1 unit mm gage number A4

modify Review Approved