

NOTE:  
 1.MATERIAL:  
 HOUSING: THERMOPLASTIC HIGH TEMP WITH 90GF,UL94V-0.  
 CONTACT: BRASS T=0.20mm  
 SHELL: BRASS T=0.50mm  
 MYLAR: KAPTON TAPE  
 2.FINISH:  
 CONTACT: GOLD PLATING ON CONTACT AREA.  
 MATTE TIN PLATING ON SOLDER TAILS  
 100u" MIN. NICKEL UNDERPLATING OVERALL.  
 SHELL: 40u"MIN. NICKEL PLATING OVERALL.

RECOMMENDED P.C.B LAYOUT (THICKNESS=1.2mm)  
 (COMPONENT SIDE) TOLERANCES ±0.05mm

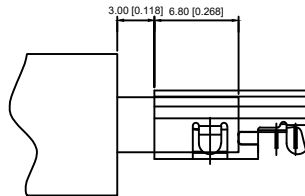
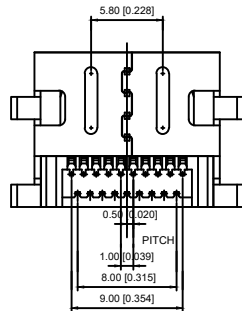
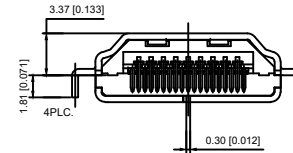
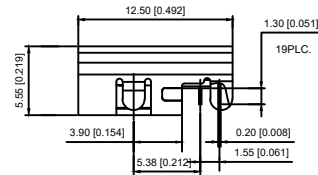
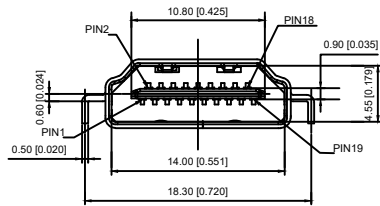

A71-05H8-1X1N1

1:AU 1U"  
 5:AU 15U"  
 6:AU 30U"

					DSND		DATE		SCALE: N/A	MODEL TYPE: HDMI CONNECTOR		
					ANGLAR	±5°	DWN		VIEW:	PART NO.:		
					L ≤ 4	±0.2	CHKD		UNIT: mm/in	DWG NO.: A71-05H8-1X1N1		
					4 < L ≤ 16	±0.3	APPD		SIZE: A4			
					16 < L ≤ 63	±0.4						
					L > 63	±0.5						
					UNSPECIFIED TOLERANCES					WEIGHT	SHEET	REVISION
					XKB INDUSTRIAL PRECISION CO., LIMITED					1.0g	1/1	A0
ΔX												
ΔX												
ΔX												
MARK	DESCRIPTION	DATE	REVISED	APPROVED								
REVISIONS												
www.xk-dg.cn www.helloxkb.com www.helloxkb.cn												