



**SPECIFICATIONS**

Rated Current:1.5AMP  
 Contact Resistance:20mΩ Max  
 Withstand Voltage:500V AC/DC  
 Insulation Resistance:1000MΩ Min  
 Operation Temperature:-40°C to +105°C

Contact Material:Brass  
 Contact Plating:Au or Sn Over Ni  
 Insulator Material:Polyester(UL94V-0)  
 Standard: PA6T  
 Max.Processing Temp: 230°C for 30-60 seconds  
 (260°C for 10 seconds)

Recommended P.C.B Layout(Top Side)  
 (PCB BOARD TOLERANCE±0.05)

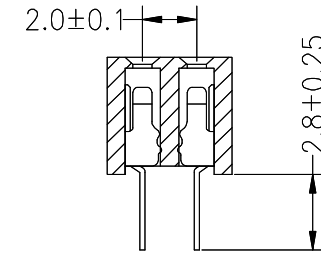
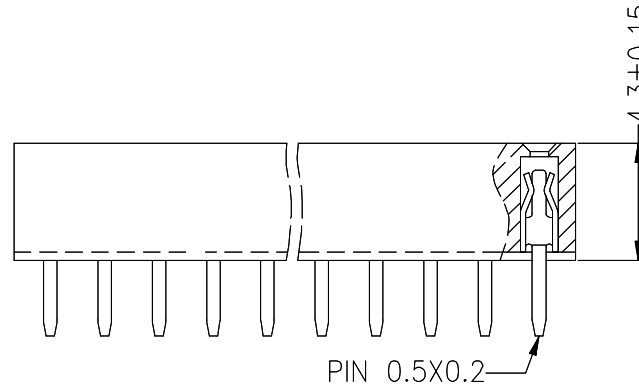
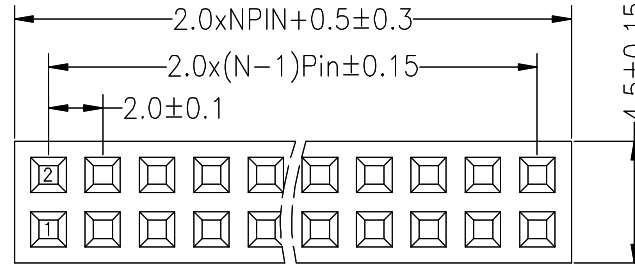
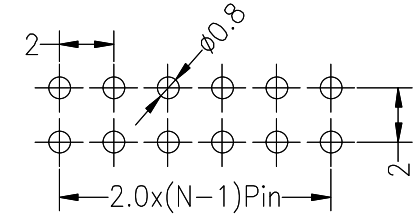

|     |      |              |             |           |       |         |           |          |       |     |   |  |
|-----|------|--------------|-------------|-----------|-------|---------|-----------|----------|-------|-----|---|--|
|     |      |              |             | OPERATION |       | DRAW    | YiYuSheng | 12.07.23 | SCALE | FIT | 深圳市华灿天禄电子有限公司<br>PART NO. PM200-2-N-Z-4.3<br>TITLE: 2.00PF H4.3mm 2xNpin 180° W4.50 |  |
|     |      |              |             | X.X       | ±0.30 |         |           |          | UNIT  | mm  |   |  |
|     |      |              |             | X.XX      | ±0.20 | CHECK   | SIZE      | A4       |       |     |   |  |
|     |      |              |             | X.XXX     | ±0.10 | APPROVE |           |          | SHEET | 1/1 |   |  |
|     |      |              |             | Angle     | ±3°   |         |           |          | PROJ. | ☉   |   |  |
| REV | DATE | MODIFICATION | DESCRIPTION | CHANGE    | DIM   | TOL     |           |          |       |     |   |  |