

2P

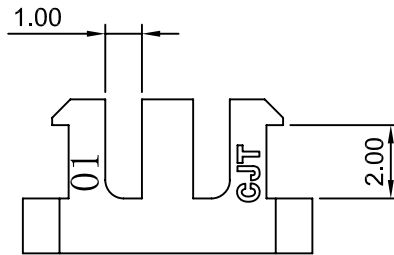

3P

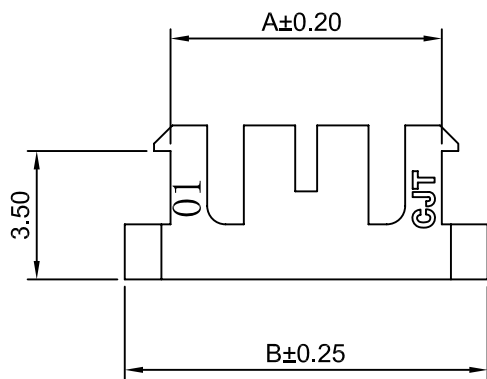
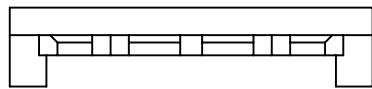
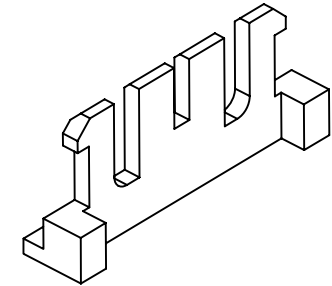

4P~16P

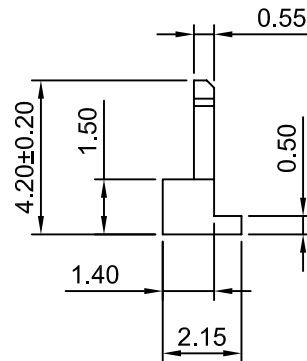

**SPECIFICATIONS:**

Current Rating: 3A AC,DC  
 Voltage Rating: 250V AC,DC  
 Temperature Range: -40°C ~ +105°C  
 Contact Resistance: 30mΩ Max.  
 Insulation Resistance: 1000MΩ Min.  
 Withstanding Voltage: 1000V AC/minute  
 Material: Nylon 66, UL94V-0(Brick red)

**Ordering Information & Dimensions**

Circuits	Dimensions(mm)		Circuits	Dimensions(mm)	
	A	B		A	B
2P	3.40	5.90	10P	19.40	21.90
3P	5.40	7.90	11P	21.40	23.90
4P	7.40	9.90	12P	23.40	25.90
5P	9.40	11.90	13P	25.40	27.90
6P	11.40	13.90	14P	27.40	29.90
7P	13.40	15.90	15P	29.40	31.90
8P	15.40	17.90	16P	31.40	33.90
9P	17.40	19.90			



CHANGJIANG CONNECTORS CO.,LTD.

Unit mm	Scale 5:1	Sheet 1 of 1
Draw BY: Tony Su	Approved : Jack Yin	

Title :  
**2.00mm PITCH**  
**Seal**

			General Tolerance	ANGLE±
A0	NEW RELEASE	2013.06.25	x.xx≤0.25 x.xxx≤0.20 x.xxxx≤0.15	
REV	DESCRIPTION	DATE		

DRAW NO : **A2008S-XP**      REV A0