

- NOTE:
1. Rating: 24V 25mA DC
  2. Insulation Resistance:  $\geq 100 \text{ M}\Omega$
  3. Withstand voltage: AC 500V 1Minute
  4. Operating Force Range: 400gf Max
  5. Mechanical Life: 3,000 Cycles
  6. Operating Temperature range  $-20^{\circ}\sim +70^{\circ}\text{C}$
  7. Ambient Humidity used:  $\leq 85\% \text{RH}$

Circuit Diagram

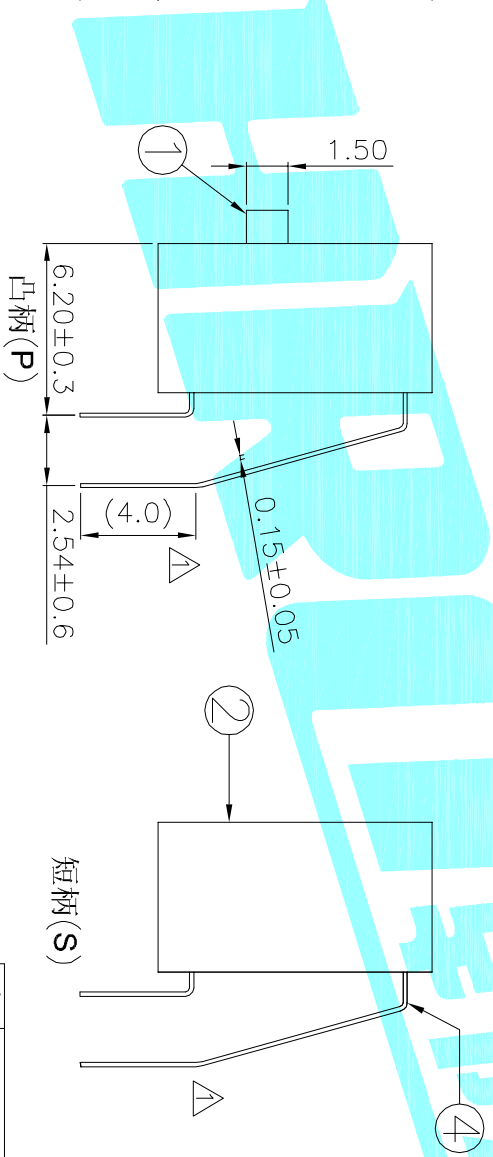

PCB Layout(Pattern Side)

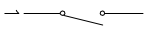
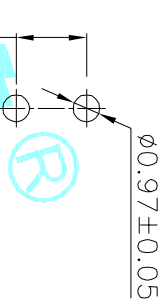

Position(位數)		1P
PART NO.	凸柄(P)	DA-01RP
蓋子/紅色(R)	短柄(S)	DA-01RS
PART NO.	凸柄(P)	DA-01BP
蓋子/藍色(B)	短柄(S)	DA-01BS

ECN NO.	REV.	DATE.	DESCRIPTION.	CHANGE.	CHECK.	APPRO.
	B					
	A		NEW			

APPROVALS		DATE	TITLE:
DRAWN	J.X.Zhang	2013/11/8	MULTIFUNCTIONAL SWITCHES
CHECKED			
APPROVALS			

TOLERANCES ARE		ANGLE	UNIT:	SCALE:	PROJ:
30°以上	±0.30		mm	1:1	
10~30	±0.20				
5~10	±0.15	±2°			
~5	±0.10				

ITEM	PART NAME	TER'NO.	QTY.	MATERIAL	FINISHING	REMARK
⑤	Gum Water	—	1	Epoxy	Black	
④	Terminal	—	2	Phosphor bronze	Au Plating	
③	Base	—	1	PBT	Black	
②	Cover	—	1	PBT	Red/Blue	
①	Keystroke	—	1	PBT	White	

APPROVALS		DATE	TITLE:
DRAWN	J.X.Zhang	2013/11/8	MULTIFUNCTIONAL SWITCHES
CHECKED			
APPROVALS			

APPROVALS		DATE	TITLE:
DRAWN	J.X.Zhang	2013/11/8	MULTIFUNCTIONAL SWITCHES
CHECKED			
APPROVALS			



HONGSHI ELECTRONICS CO., LTD

PART NO. DA-01RP

SCALE: 1:1

SHEET 1 OF 1